

CHAINAGE	EXISTING GROUND LEVEL	ALIGNMENT LEVEL	VERTICAL ALIGNMENT	HORIZONTAL ALIGNMENT	STORMWATER COVER LEVEL	STORMWATER INVERT	FOULWATER COVER LEVEL	FOULWATER INVERT
0+000	21.000	21.000	G = -5.00%	R = 100.000	21.000	Pipe 1.000 Dia 150 Circular PVC-U 1 in 15 68.276	19.500	17.000
10+000	21.000	21.000	L = 20.000 KF = -6.0		21.000	Pipe 2.007 Dia 300 Circular PVC-U 1 in 15 69.472	19.500	17.000
20+000	21.000	21.000	G = -5.00%	R = 100.000	21.000	Pipe 2.008 Dia 300 Circular PVC-U 1 in 15 69.472	19.500	17.000
30+000	21.000	21.000	G = -5.00%		21.000	Pipe 2.007 Dia 300 Circular PVC-U 1 in 15 69.472	19.500	17.000
40+000	21.000	21.000	G = -5.00%		21.000	Pipe 2.007 Dia 300 Circular PVC-U 1 in 15 69.472	19.500	17.000
50+000	21.000	21.000	G = -5.00%		21.000	Pipe 2.007 Dia 300 Circular PVC-U 1 in 15 69.472	19.500	17.000
60+000	21.000	21.000	G = -5.00%		21.000	Pipe 2.007 Dia 300 Circular PVC-U 1 in 15 69.472	19.500	17.000
70+000	21.000	21.000	G = -5.00%		21.000	Pipe 2.007 Dia 300 Circular PVC-U 1 in 15 69.472	19.500	17.000
80+000	21.000	21.000	G = -5.00%		21.000	Pipe 2.007 Dia 300 Circular PVC-U 1 in 15 69.472	19.500	17.000
90+000	21.000	21.000	G = -5.00%		21.000	Pipe 2.007 Dia 300 Circular PVC-U 1 in 15 69.472	19.500	17.000
100+000	21.000	21.000	G = -5.00%		21.000	Pipe 2.007 Dia 300 Circular PVC-U 1 in 15 69.472	19.500	17.000

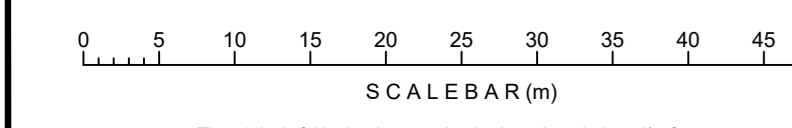

© Copyright The original of this drawing contained coloured symbols and/or features. Any black and white reproduction should not refer to them.

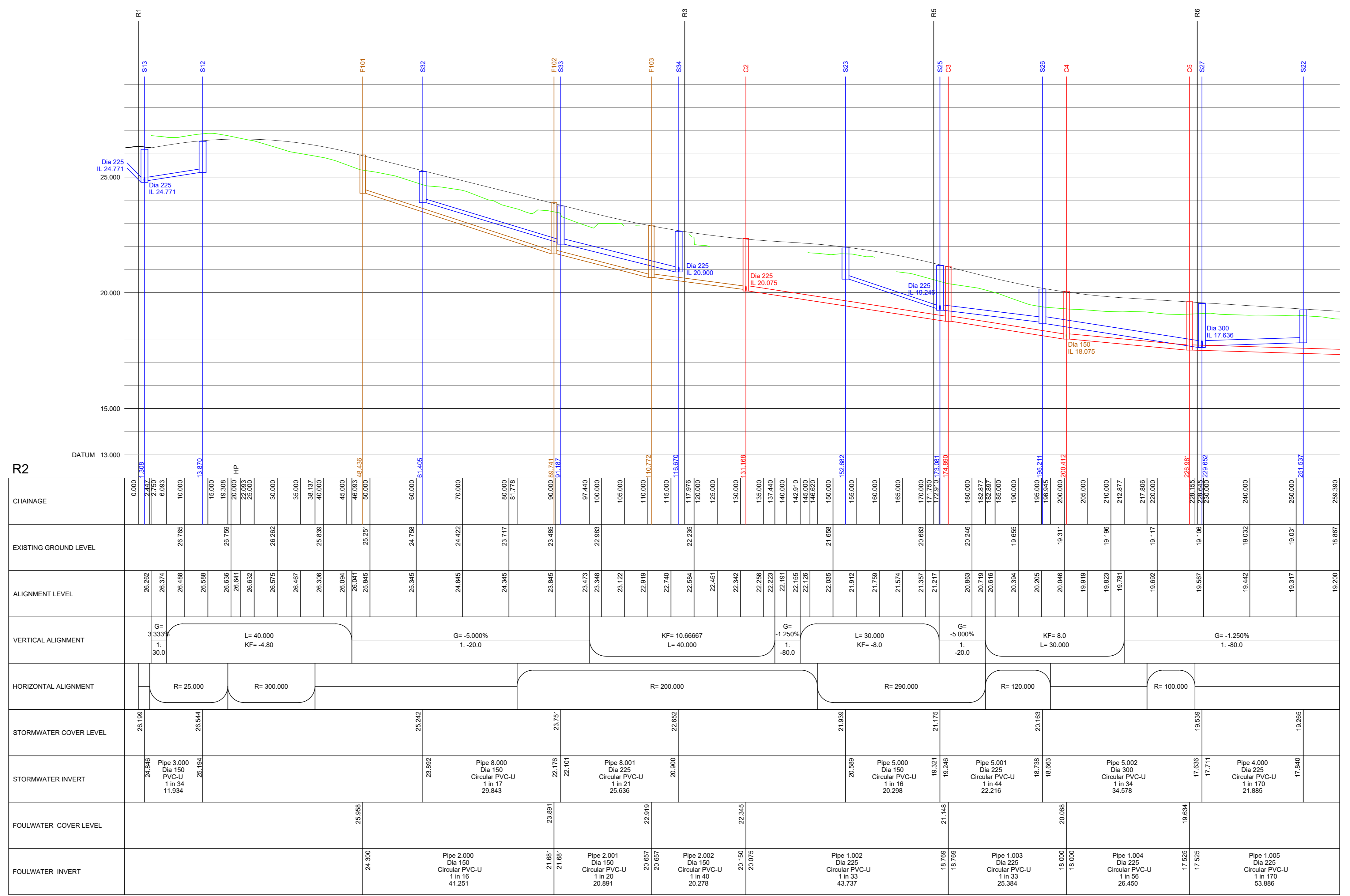

CHAINAGE	EXISTING GROUND LEVEL	ALIGNMENT LEVEL	VERTICAL ALIGNMENT	HORIZONTAL ALIGNMENT	STORMWATER COVER LEVEL	STORMWATER INVERT	FOULWATER COVER LEVEL	FOULWATER INVERT
0+000	21.000	21.000	G = -5.00%	R = 120.000	21.000	Pipe 5.002 Dia 300 Circular PVC-U 1 in 15 69.472	19.500	17.000
10+000	21.000	21.000	L = 20.000 KF = -6.0		21.000	Pipe 5.002 Dia 300 Circular PVC-U 1 in 15 69.472	19.500	17.000
20+000	21.000	21.000	G = -5.00%	R = 30.000	21.000	Pipe 5.002 Dia 300 Circular PVC-U 1 in 15 69.472	19.500	17.000
30+000	21.000	21.000	G = -5.00%		21.000	Pipe 5.002 Dia 300 Circular PVC-U 1 in 15 69.472	19.500	17.000
40+000	21.000	21.000	G = -5.00%		21.000	Pipe 5.002 Dia 300 Circular PVC-U 1 in 15 69.472	19.500	17.000
50+000	21.000	21.000	G = -5.00%		21.000	Pipe 5.002 Dia 300 Circular PVC-U 1 in 15 69.472	19.500	17.000
60+000	21.000	21.000	G = -5.00%		21.000	Pipe 5.002 Dia 300 Circular PVC-U 1 in 15 69.472	19.500	17.000
70+000	21.000	21.000	G = -5.00%		21.000	Pipe 5.002 Dia 300 Circular PVC-U 1 in 15 69.472	19.500	17.000
80+000	21.000	21.000	G = -5.00%		21.000	Pipe 5.002 Dia 300 Circular PVC-U 1 in 15 69.472	19.500	17.000
90+000	21.000	21.000	G = -5.00%		21.000	Pipe 5.002 Dia 300 Circular PVC-U 1 in 15 69.472	19.500	17.000
100+000	21.000	21.000	G = -5.00%		21.000	Pipe 5.002 Dia 300 Circular PVC-U 1 in 15 69.472	19.500	17.000

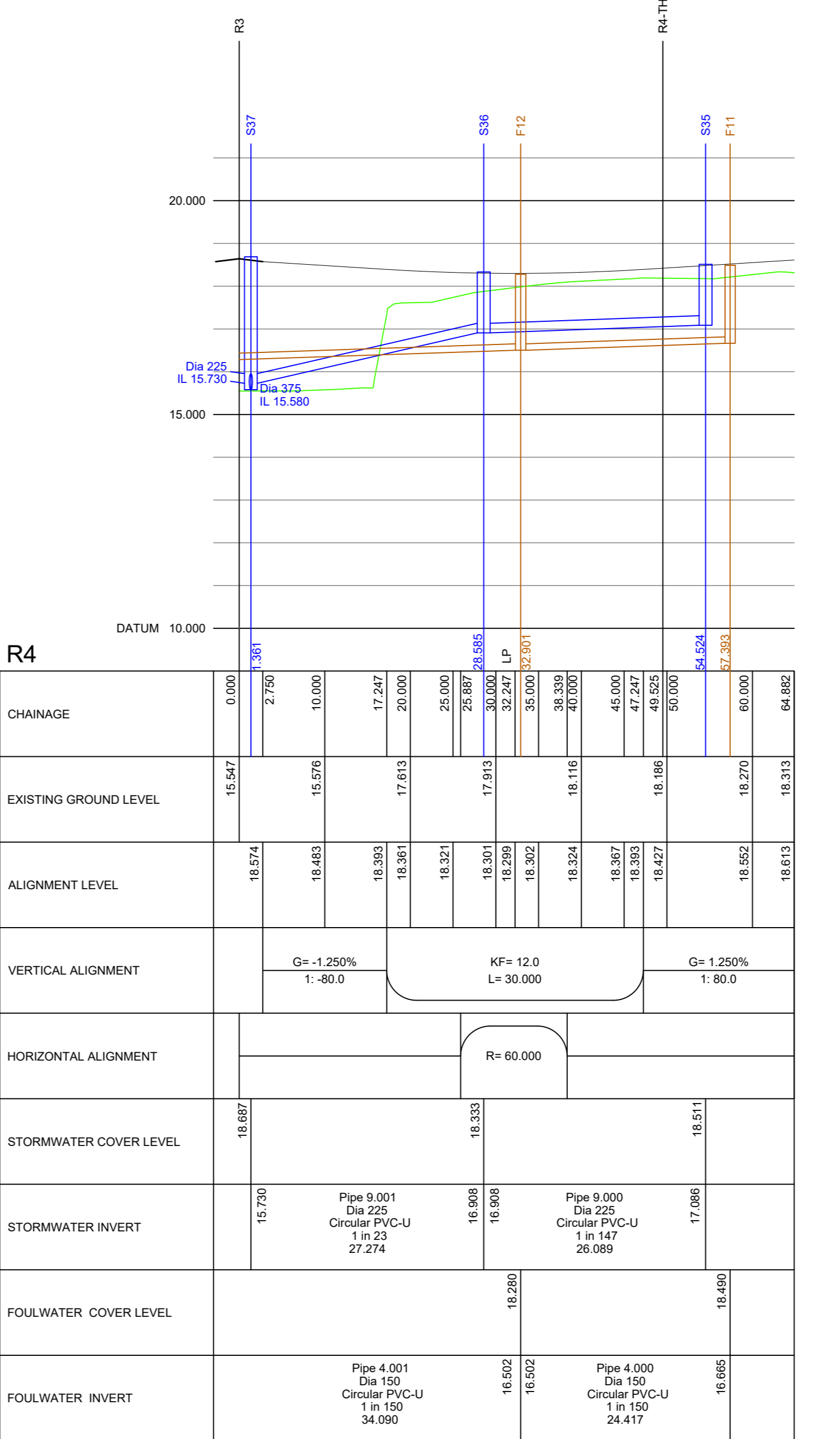

© Copyright The original of this drawing contained coloured symbols and/or features. Any black and white reproduction should not refer to them.

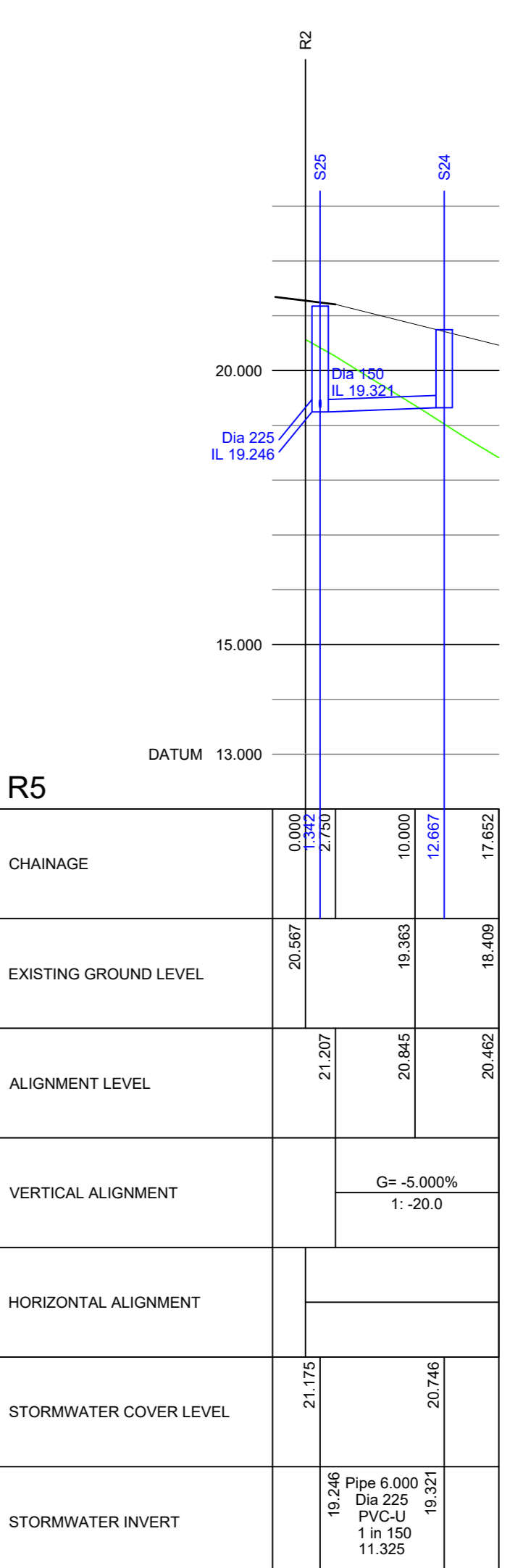

© Copyright The original of this drawing contained coloured symbols and/or features. Any black and white reproduction should not refer to them.

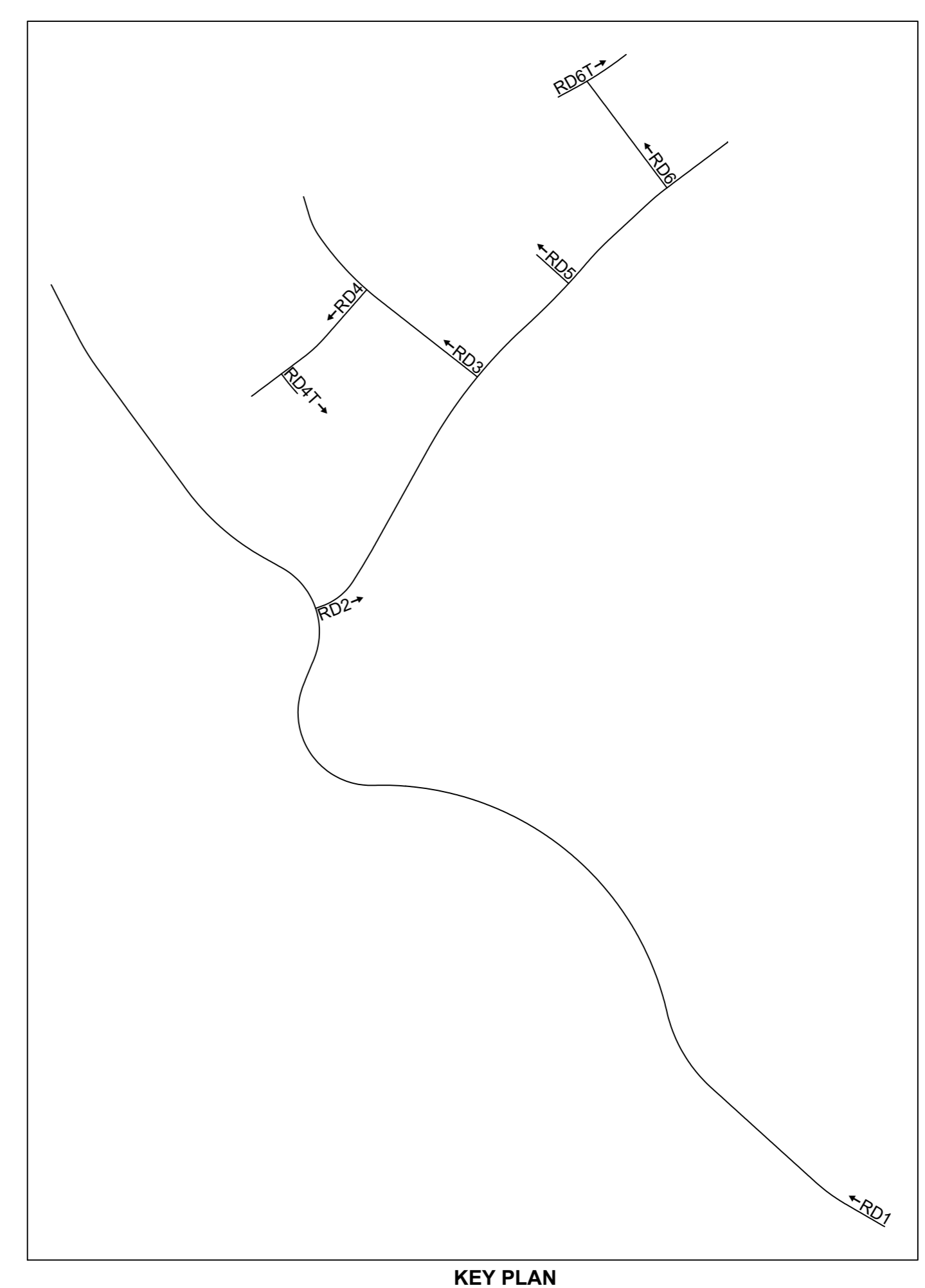

- Notes**
- Setting out shall be undertaken using only the information given. Distances should not be scaled from this drawing.
  - All sewers shall be constructed in accordance with Sewers for Adoption 7th Edition and Welsh Water Details & Guidelines.
  - The minimum gravity pipe diameter under adoptable highways shall be 150mm.
  - It is the responsibility of the Contractor to verify all information given with regards to existing services and drainage connections etc. prior to commencing the works. The rates shall include for hand dig around services where necessary. The Contractor shall adhere to the CDM Regulations at all times.
  - The outsides of all sewers shall be a minimum of 1.0m from kerb lines and the outside of manholes shall be a minimum of 0.5m from kerb lines.
  - Existing flows in watercourses, sewers and land drains shall be maintained at all times.
  - Only trained personnel shall be permitted to enter confined spaces.
  - All materials to be used shall be the relevant B.S. Kitemark and comply fully with the specifications. All concrete & concrete products must use Sulphate resistant cement to withstand Class 3 condition (unless the site investigation report proves that sulphate attack from soils and groundwater will not occur).
  - All opening notices etc. as required under Highways Acts etc. are to be obtained prior to commencement of works. All works are to be inspected by L.A., NHBC or the Network Operator as applicable.
  - Where "structured wall" UPVC pipes are used in adoptable drainage they shall be handled and laid in accordance with the manufacturers instructions and will be subject to post installation deformation testing prior to adoption. A Class S Bed and Surround must be used for such pipes.
  - Trench backfill in highways to within 1m of highway shall, as directed by the Highway Authority be a suitable granular material all in accordance with Sewers for Adoption.
  - Slab levels shall not be varied without reference to the Engineer for guidance.
  - Pipes have not been designed to accommodate construction traffic loading. The contractor is responsible for providing adequate protection to the pipes during construction.
  - All works to be in accordance with Denbighshire County Council's Specification and Standard Details, and as agreed with Denbighshire County Council's representative.
  - The developer must self-certify and certify that the design criteria, material standards and workmanship specifications for the proposed adoptable sewers are in accordance with those set out in "Sewers for Adoption" 7th Edition (SFA 7th), The Welsh Ministers Standards and the requirement of DCWW as the Statutory Sewerage Undertaker.
  - Subject to a Section 104 Adoption Agreement being complete, a Section 106 application to connect must be made to DCWW the developer shall be given 21 days notice prior to connection. The works may only be undertaken by an SSIP Health & Safety approved contractor.

**Pipe Materials Table**

Pipe Materials Table	Pipe Materials Table
100	CLAYWARE
150	CLAYWARE
225	CLAYWARE
300	CLAYWARE
375	CONCRETE
450	CONCRETE
525	CONCRETE

Contractor may elect to use thermoplastics pipes. These shall comply with the relevant provisions of BS EN 1401-1, BS EN 1852 and BS EN 12666-1 and should be Welsh Water approved products

**Bedding and Surround Table**

Depth to Soffit	Bedding and Surround Type
>1.2m	Class S
<1.2m	Class Z

**Note:**  
Adoptable materials / workmanship to conform to Part E of "Sewers for Adoption" 7th Edition.

**STRATEGY**

**coopers**  
chartered consulting engineers

Tel: 01244 684910  
Email: admin@coopers.co.uk  
Web: http://coopers.co.uk

Park House  
Serpentine Court  
Chester Business Park  
Chester  
CH4 3QU



Client  
**MINDALE FARM, MELIDEN.**

Title  
**Highway Longsections Sheet 2 of 3**

DRAWING NUMBER	SCALE at A0	1:500 H & 1:100 V
8658 / SK02-2	DATE	09.12.25
	DRAWN	PW
	CHECKED	AJ
	REVISION	-