

Recreation Ground

Bowling Green

DO NOT SCALE
 ALL COORDINATES RELATED TO LOCAL GRID LOCATED TO OS NG BY BEST FIT TO DETAIL, EXTRACTED FROM OS DIGITAL DATA.
 © This drawing, including the design and technical information contained on it, is the property of Ascerta. The drawing may only be used for the specific purpose for which it has been intended and may not be reproduced or copied without prior permission.

- Planting Plan Key:**
- Site Boundary
 - Existing trees and hedgerows to be retained and protected during the works.
 - Existing trees and hedgerow to be removed.
 - Proposed ornamental planting on 450mm depth of topsoil with 75mm bark mulch.
 - Proposed native tree planting, tree pit and double staking as detailed in the specification.
 - Proposed ornamental tree planting, tree pit and double staking as detailed in the specification.
 - Proposed mixed native hedgerow planted in a double staggered row at 0.3m centres and 0.3 offset (6 no. plants per linear metre). Bare root transplants (common holly in containers), each with a 60cm high Tubes shrub shelter, two cable ties and a timber stake.
 - Proposed single species formal hedge planted 5 no. plants per linear metre. Container transplants.
 - Front gardens to be turfed with Lindum LT7 Festival Landscape Turf (or similar approved) on 200mm topsoil.
 - Public open space to be sown with Geminal AberSustain mix, or similar approved, to be sown at a rate of 40g/m2 on 200mm topsoil.
 - Public open space to be sown with Geminal Eco Species Rich Lawn mix, or similar approved, to be sown at a rate of 10g/m2 on 200mm topsoil.
 - Native scrub planting to be planted as mainly 60-80cm whip planting at 1m centres, for additional wildlife habitat.
 - Native woodland mix planting to be planted as mainly 60-80cm whip planting at 2m centres, for additional wildlife habitat.
 - Willflower seeding, Geminal RE3 River Floodplain / Water Meadow (MGB Grassland), to the existing water course within public open space to be sown at 5g/m2 planted into 200mm of a mix of topsoil and subsoil (50:50).
 - Willflower seeding, WF19 Pollinators Paradise, to the public open space to be sown at 2g/m2 planted into 200mm of a mix of topsoil and subsoil (50:50).

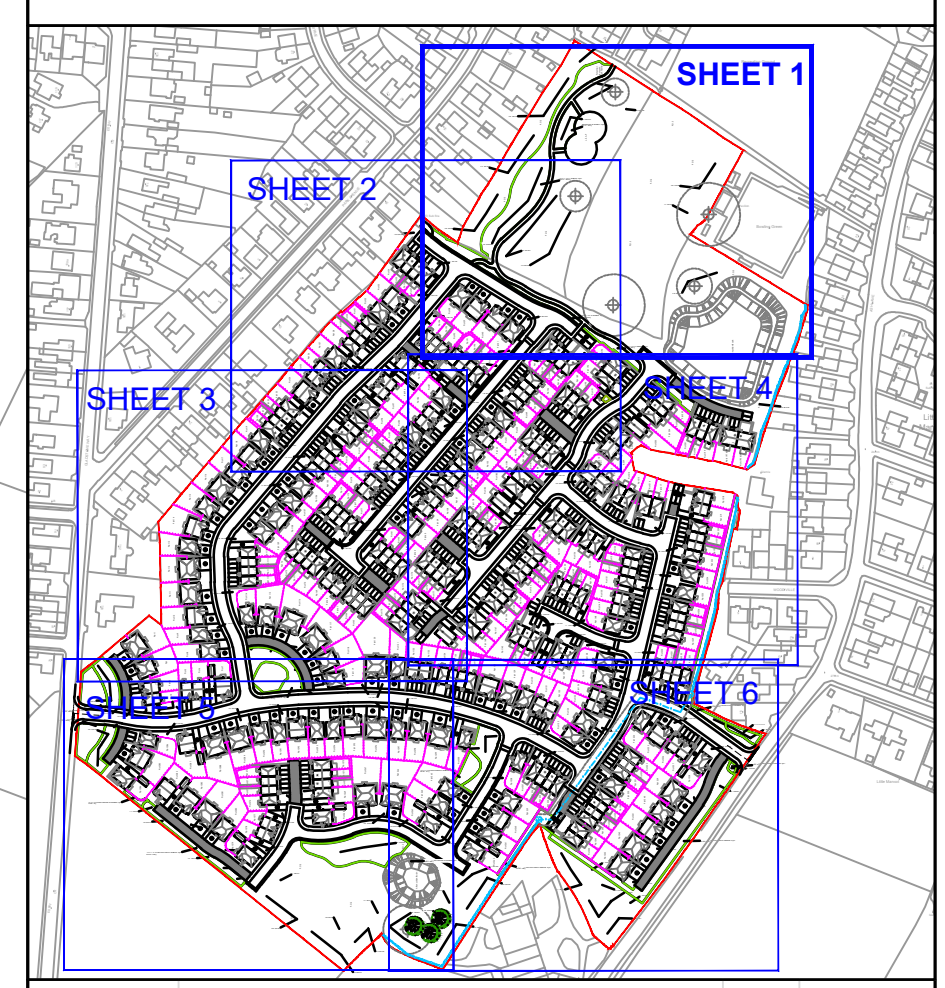
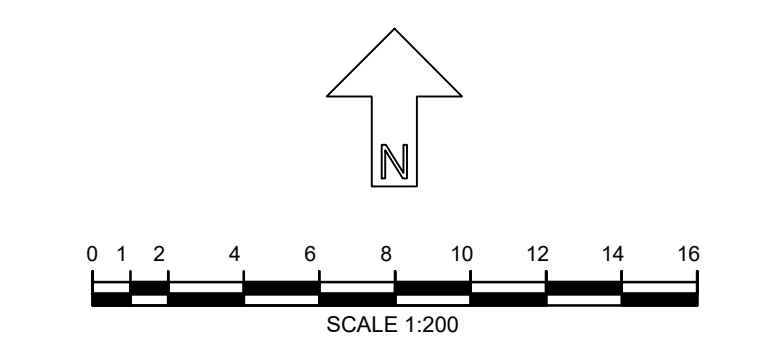

REV	DESCRIPTION	BY	DATE
A	updated to layout "Rev C"	CP	15/11/23

Ascerta
 Landscape | Trees | Ecology
 t: 0845 463 4404
 e: info@landscapetreecology.com
 www.landscapetreecology.com

CLIENT: Castle Green Homes
 PROJECT: Gladstone Way, Hawarden
 DRAWING TITLE: Planting Plan (Sheet 1 of 6)
 SCALE: 1:200 @ A0 DRAWING No: REV: GJH/CP CN DATE: 19/10/2023 P.1915.23.04 A

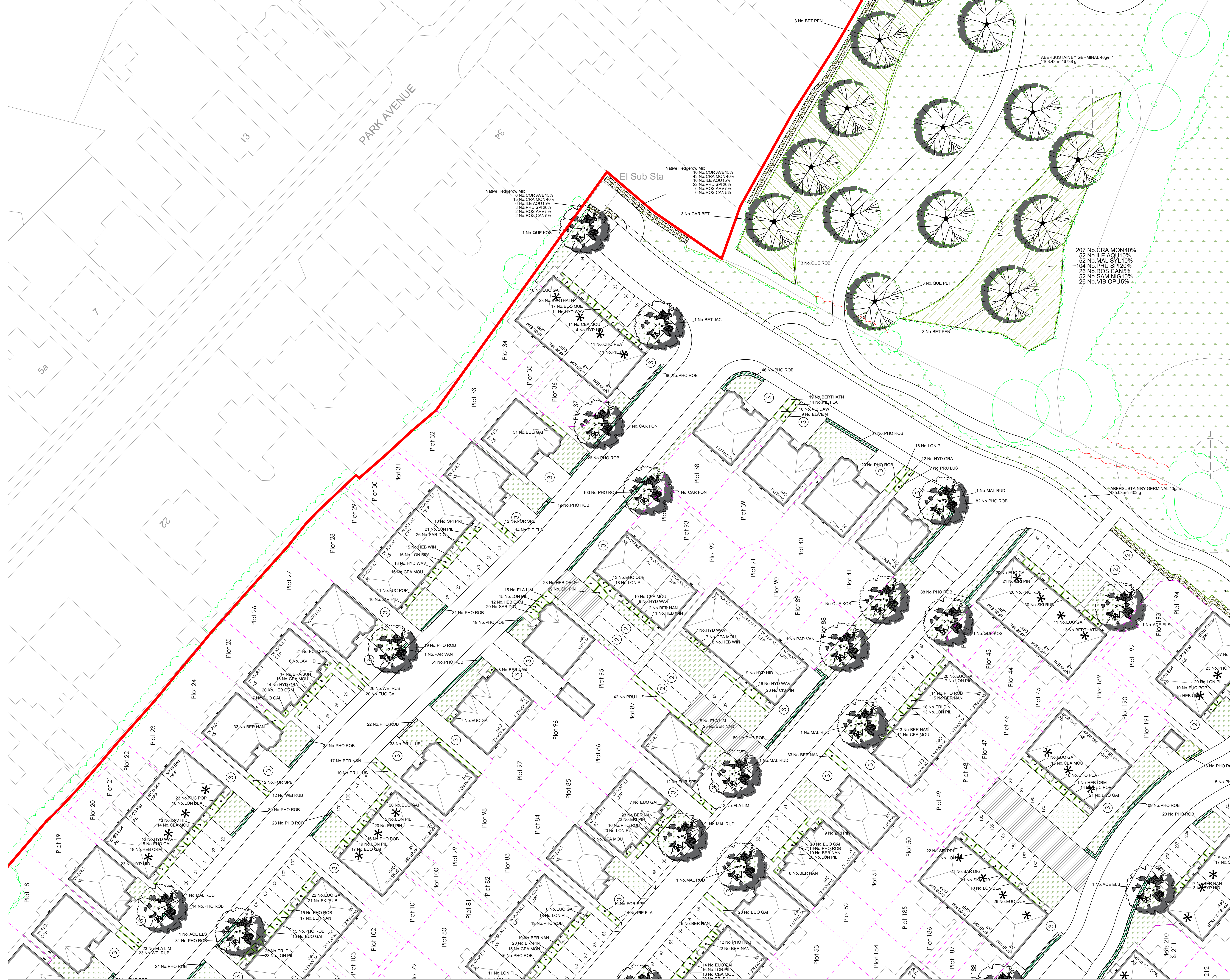

DO NOT SCALE
 ALL COORDINATES RELATED TO LOCAL GRID LOCATED TO OS NGR BY BEST FIT TO DETAIL EXTRACTED FROM OS DIGITAL DATA
 © This drawing, including the design and technical information contained on it, is the property of Ascerta. The drawing may only be used for the specific purpose for which it has been intended and may not be reproduced or copied without prior permission.

- Planting Plan Key:**
- Site Boundary
 - Existing trees and hedgerows to be retained and protected during the works.
 - Existing trees and hedgerow to be removed.
 - Proposed ornamental planting on 450mm depth of topsoil with 75mm bark mulch.
 - Proposed native tree planting, tree pit and double staking as detailed in the specification.
 - Proposed ornamental tree planting, tree pit and double staking as detailed in the specification.
 - Proposed mixed native hedgerow planted in a double staggered row at 0.33m centres and 0.3 offset (8 no. plants per linear metre). Bare root transplants (common holly in containers), each with a 60cm high Tubes shrub shelter, two cable ties and a timber stake.
 - Proposed single species formal hedge planted 5 no. plants per linear metre. Container transplants.
 - Front gardens to be turfed with Limer LT7 Festival Landscape Turf (or similar approved) on 200mm topsoil.
 - Public open space to be sown with Germal AberSustain mix, or similar approved, to be sown at a rate of 40g/m2 on 200mm topsoil.
 - Public open space to be sown with Germal Eco Species Rich Lawn mix, or similar approved, to be sown at a rate of 10g/m2 on 200mm topsoil.
 - Native scrub planting to be planted as mainly 60-80cm whip planting at 1m centres, for additional wildlife habitat.
 - Native woodland mix planting to be planted as mainly 60-80cm whip planting at 2m centres, for additional wildlife habitat.
 - Wildflower seeding, Germal RE3 River Floodplain / Water Meadow (MGB Grassland), to the existing water course within public open space to be sown at 5g/m2 planted into 200mm of a mix of topsoil and subsoil (50:50).
 - Wildflower seeding, WP19 Pollinators Paradise, to the public open space to be sown at 2g/m2 planted into 200mm of a mix of topsoil and subsoil (50:50).

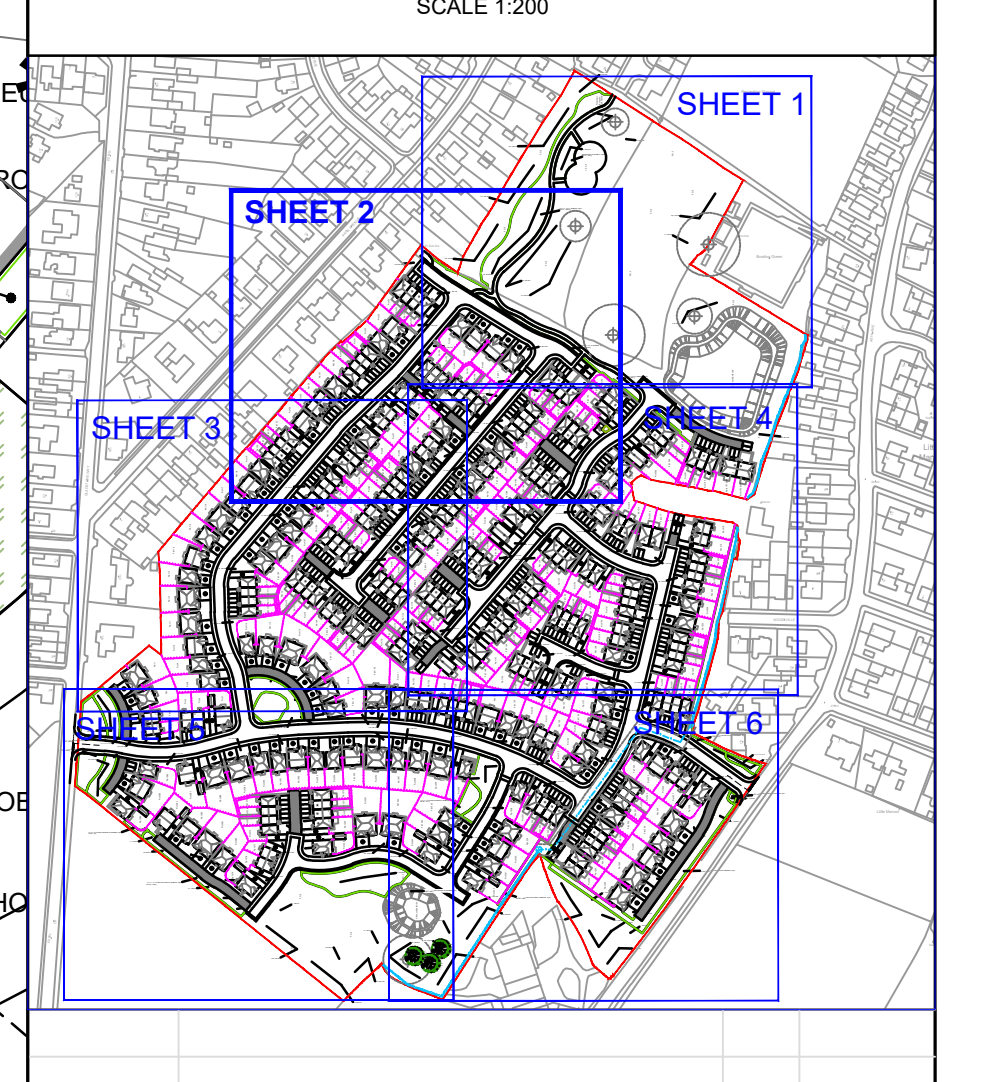
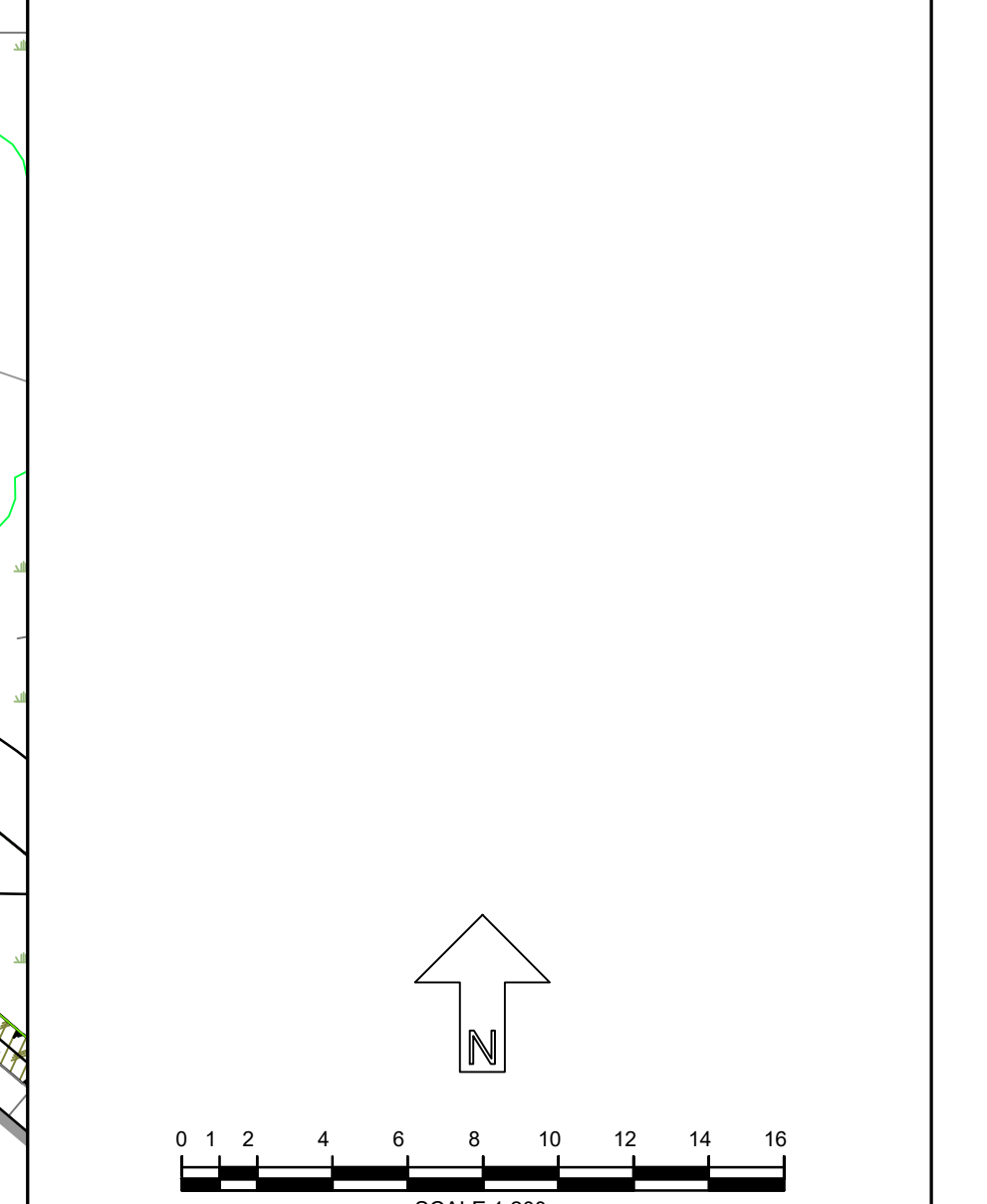

updated to layout "Rev C" CP 15/11/23
 REV DESCRIPTION BY DATE

Ascerta
 Landscape | Trees | Ecology
 t: 0845 463 4404
 e: info@landscapeecology.com
 www.landscapeecology.com

CLIENT: Castle Green Homes
 PROJECT: Gladstone Way, Hawarden
 DRAWING TITLE: Planting Plan (Sheet 2 of 6)
 SCALE: 1:200 @ A0 DRAWING No: REV
 DRAWN BY: CHD BY DATE: 19/10/2023 P.1915.23.04 A
 GJH/CP CN

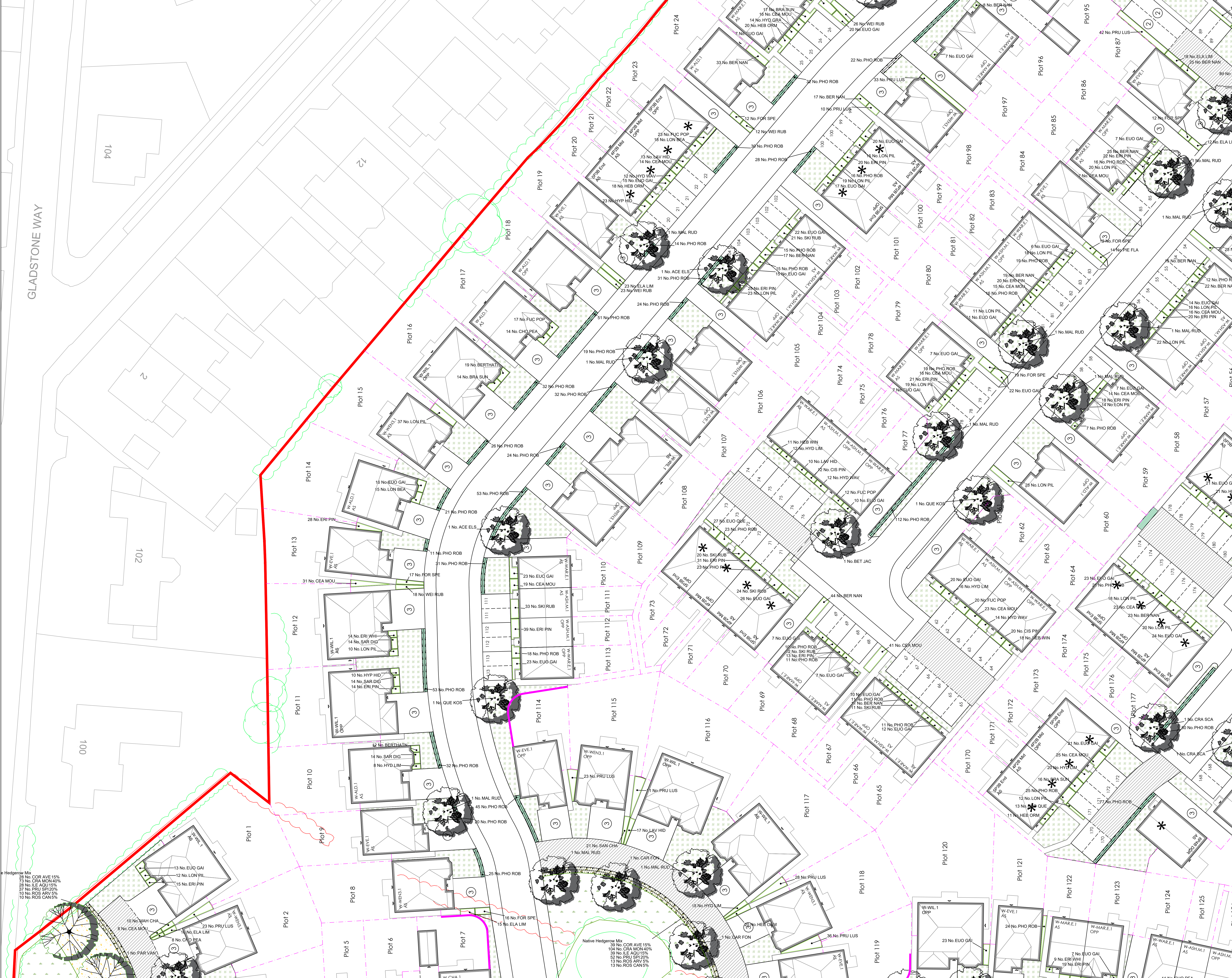

DO NOT SCALE
 ALL COORDINATES RELATED TO LOCAL GRID LOCATED TO OS NO 8Y BEST FIT TO DETAIL EXTRACTED FROM OS DIGITAL DATA
 This drawing, including the design and technical information contained on it, is the property of Ascerta. The drawing may only be used for the specific purpose for which it has been intended and may not be reproduced or copied without prior permission.

- Planting Plan Key:**
- Site Boundary
 - Existing trees and hedgerows to be retained and protected during the works.
 - Existing trees and hedgerow to be removed.
 - Proposed ornamental planting on 450mm depth of topsoil with 75mm bark mulch.
 - Proposed native tree planting, tree pit and double staking as detailed in the specification.
 - Proposed ornamental tree planting, tree pit and double staking as detailed in the specification.
 - Proposed mixed native hedgerow planted in a double staggered row at 0.33m centres and 0.3 offset (8 no. plants per linear metre). Bare root transplants (common holly in containers), each with a 60cm high Tubes shrub shelter, two cable ties and a timber stake.
 - Proposed single species formal hedge planted 5 no. plants per linear metre. Container transplants.
 - Front gardens to be turfed with Lindum LT7 Festival Landscape Turf (or similar approved) on 200mm topsoil.
 - Public open space to be sown with Geminal AberSustain mix, or similar approved, to be sown at a rate of 40g/m2 on 200mm topsoil.
 - Public open space to be sown with Geminal Eco Species Rich Lawn mix, or similar approved, to be sown at a rate of 10g/m2 on 200mm topsoil.
 - Native scrub planting to be planted as mainly 60-80cm whip planting at 1m centres, for additional wildlife habitat.
 - Native woodland mix planting to be planted as mainly 60-80cm whip planting at 2m centres, for additional wildlife habitat.
 - Willowfower seeding, Geminal RE3 River Floodplain / Water Meadow (MGB Grassland), to the existing water course within public open space to be sown at 5g/m2 planted into 200mm of a mix of topsoil and subsoil (50:50).
 - Willowfower seeding, Geminal RE3 River Floodplain / Water Meadow (MGB Grassland), to the existing water course within public open space to be sown at 2g/m2 planted into 200mm of a mix of topsoil and subsoil (50:50).

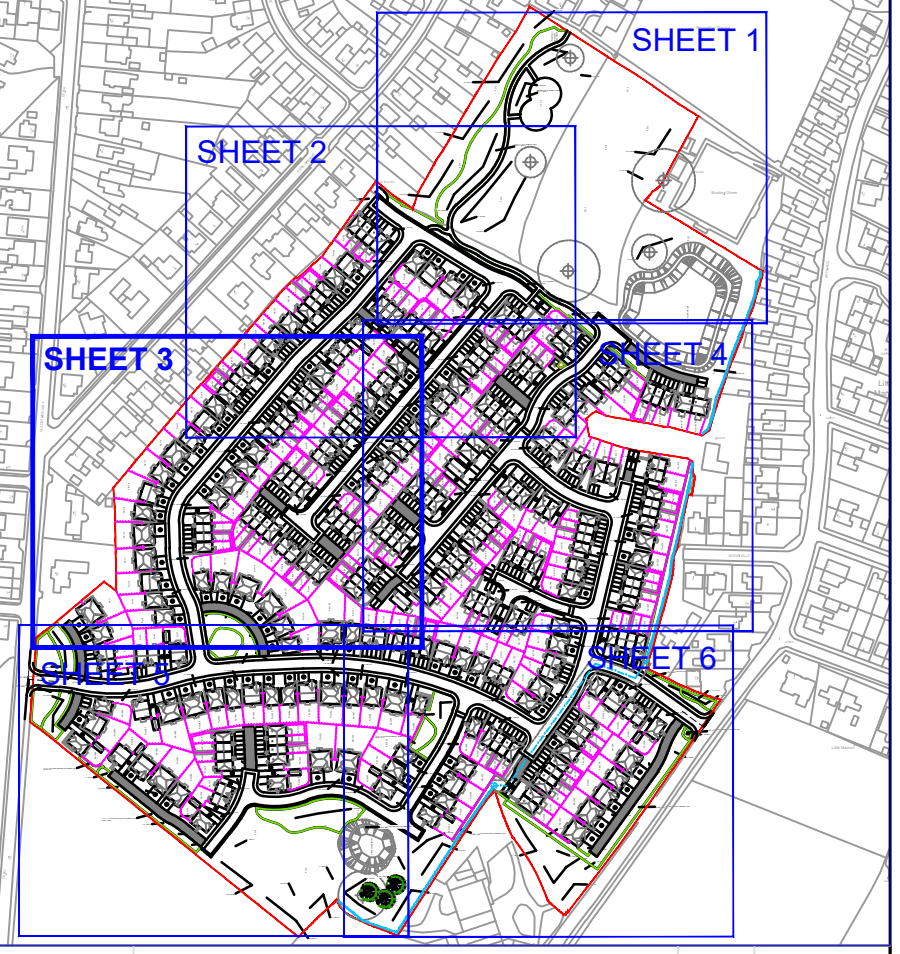
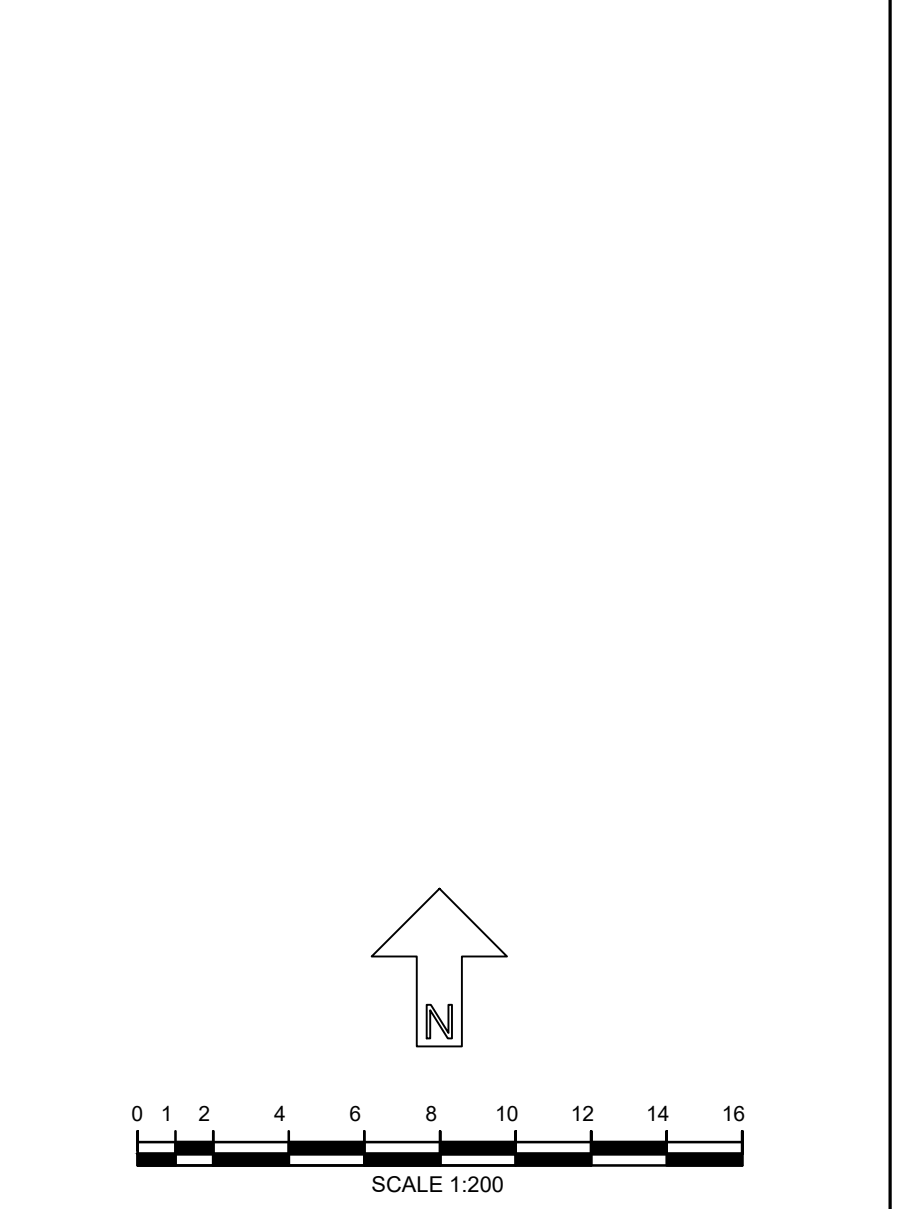

A updated to layout "Rev C" CP 15/11/23
 REV DESCRIPTION BY DATE

Ascerta
 Landscape | Trees | Ecology
 t: 0845 463 4404
 e: info@landscapeecology.com
 www.landscapeecology.com

CLIENT: Castle Green Homes
 PROJECT: Gladstone Way, Hawarden
 DRAWING TITLE: Planting Plan (Sheet 3 of 6)
 SCALE: 1:200 @ A0 DRAWING No: P.1915.23.04
 DRAWN BY: GJH/CP CN DATE: 19/10/2023 P.1915.23.04 A

Hedgerow Mix
 25 No. COR AVE 15%
 28 No. CRA MON 40%
 28 No. LLE AQU 15%
 37 No. PRU SPI 20%
 10 No. ROS ARV 5%
 10 No. ROS CAN 5%

Native Hedgerow Mix
 39 No. COR AVE 15%
 104 No. CRA MON 40%
 39 No. LLE AQU 15%
 52 No. PRU SPI 20%
 13 No. ROS ARV 5%
 13 No. ROS CAN 5%

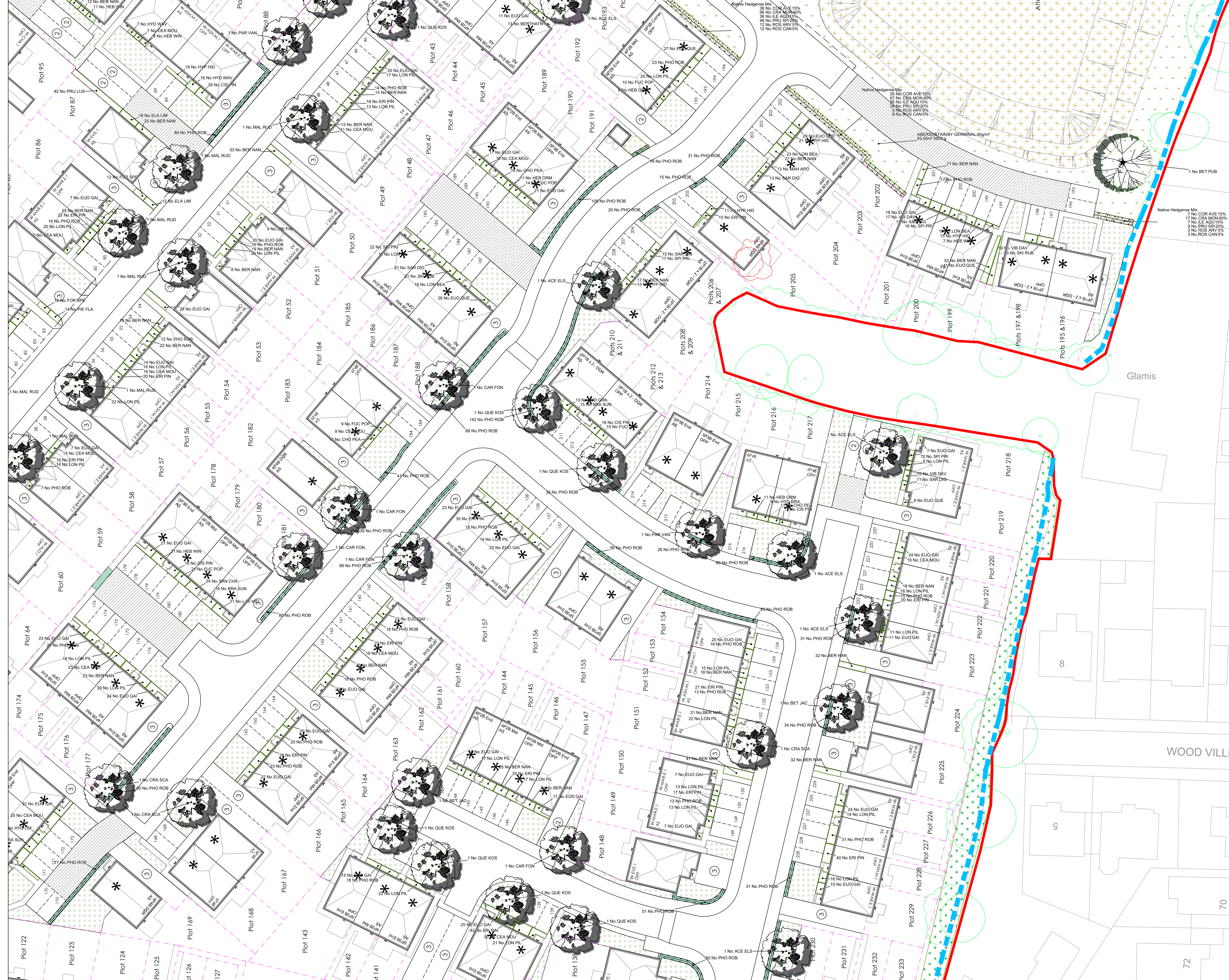

DO NOT SCALE

ALL COORDINATES RELATED TO LOCAL GRID LOCATED TO OS NG BY BEST FIT TO DETAIL EXTRACTED FROM OS DIGITAL DATA

This drawing, including the design and technical information contained on it, is the property of Ascerta. The drawing may only be used for the specific purpose for which it has been intended and may not be reproduced or copied without prior permission.

- Planting Plan Key:**
- Site Boundary
 - Existing trees and hedgerows to be retained and protected during the works.
 - Existing trees and hedgerow to be removed.
 - Proposed ornamental planting on 450mm depth of topsoil with 75mm bark mulch.
 - Proposed native tree planting, tree pit and double staking as detailed in the specification.
 - Proposed ornamental tree planting, tree pit and double staking as detailed in the specification.
 - Proposed mixed native hedgerow planted in a double staggered row at 0.33m centres and 0.3 offset (8 no. plants per linear metre). Bare root transplants (common holly in containers), each with a 60cm high Tubes shrub shelter, two cable ties and a timber stake.
 - Proposed single species formal hedge planted 5 no. plants per linear metre. Container transplants.
 - Front gardens to be turfed with Lindum LT7 Festival Landscape Turf (or similar approved) on 200mm topsoil.
 - Public open space to be sown with Geminal AberSustain mix, or similar approved, to be sown at a rate of 40g/m2 on 200mm topsoil.
 - Public open space to be sown with Geminal Eco Species Rich Lawn mix, or similar approved, to be sown at a rate of 10g/m2 on 200mm topsoil.
 - Native scrub planting to be planted as mainly 60-80cm whip planting at 1m centres, for additional wildlife habitat.
 - Native woodland mix planting to be planted as mainly 60-80cm whip planting at 2m centres, for additional wildlife habitat.
 - Wildflower seeding, Geminal RE3 River Floodplain / Water Meadow (MGB Grassland), to the existing water course within public open space to be sown at 5g/m2 planted into 200mm of a mix of topsoil and subsoil (50:50).
 - Wildflower seeding, WF19 Pollinators Paradise, to the public open space to be sown at 2g/m2 planted into 200mm of a mix of topsoil and subsoil (50:50).

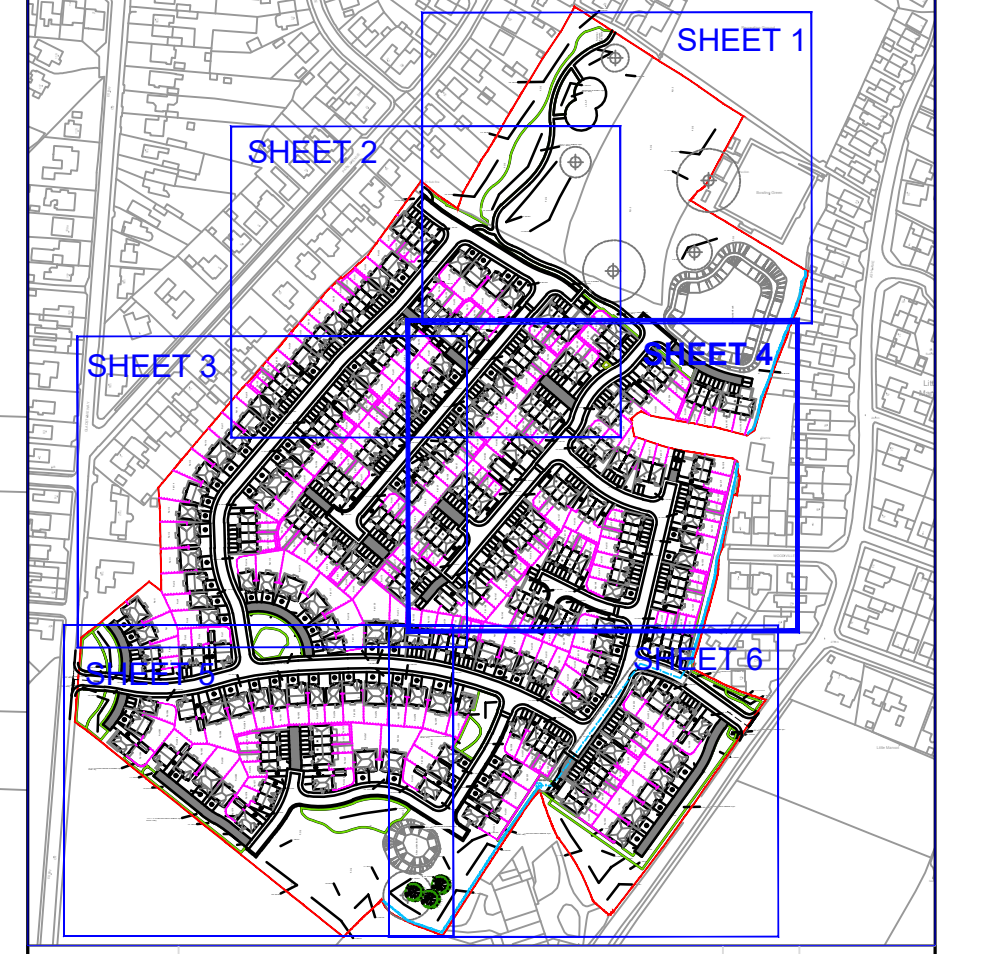
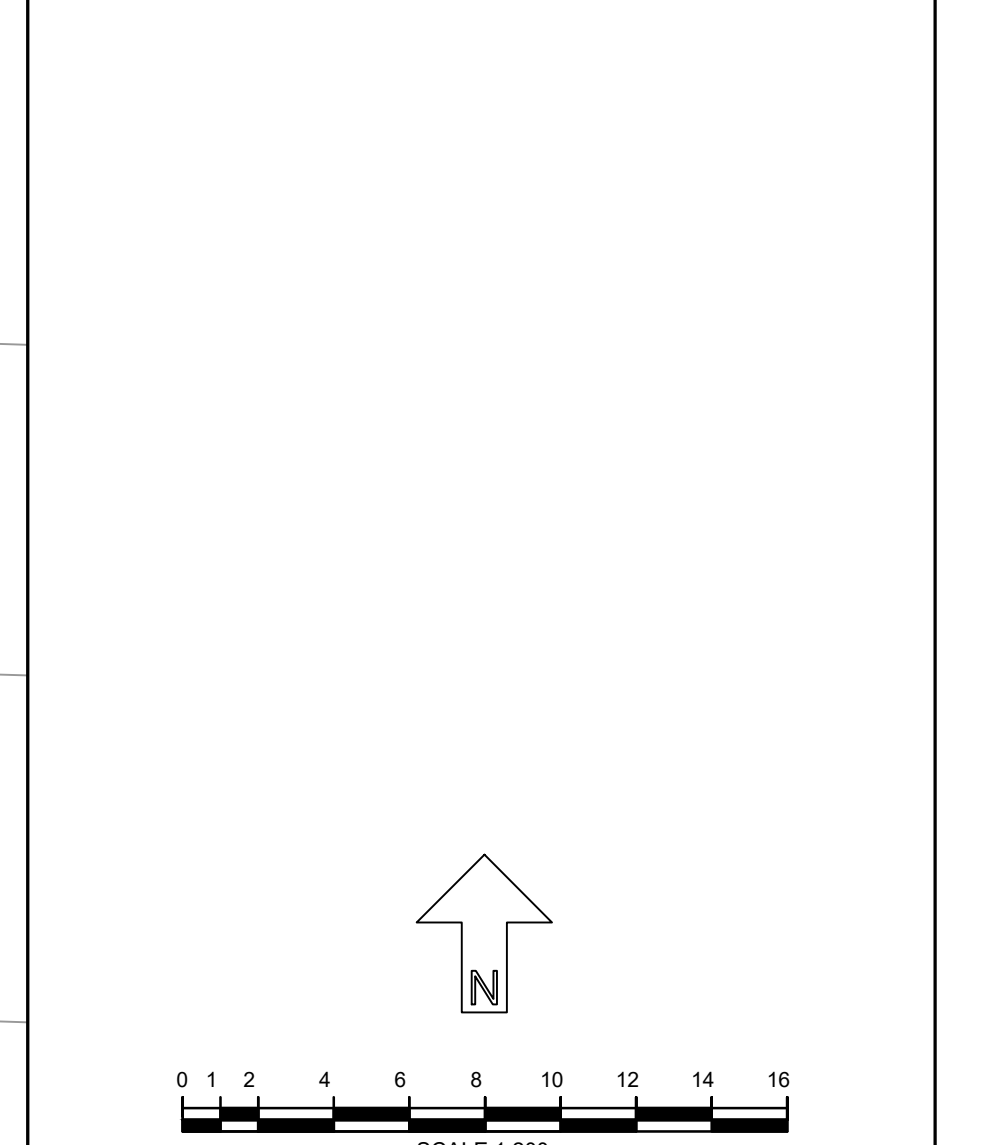

updated to layout "Rev C" CP 15/1/23

REV	DESCRIPTION	BY	DATE
A			

Ascerta
Landscape | Trees | Ecology

t: 0845 463 4404
e: info@landscapetreecology.com
www.landscapetreecology.com

CLIENT: Castle Green Homes
PROJECT: Gladstone Way, Hawarden
DRAWING TITLE: Planting Plan (Sheet 4 of 6)
SCALE: 1:200 @ A0 DRAWING No: REV
DRAWN BY: CHD BY DATE: 19/10/2023 P.1915.23.04 A

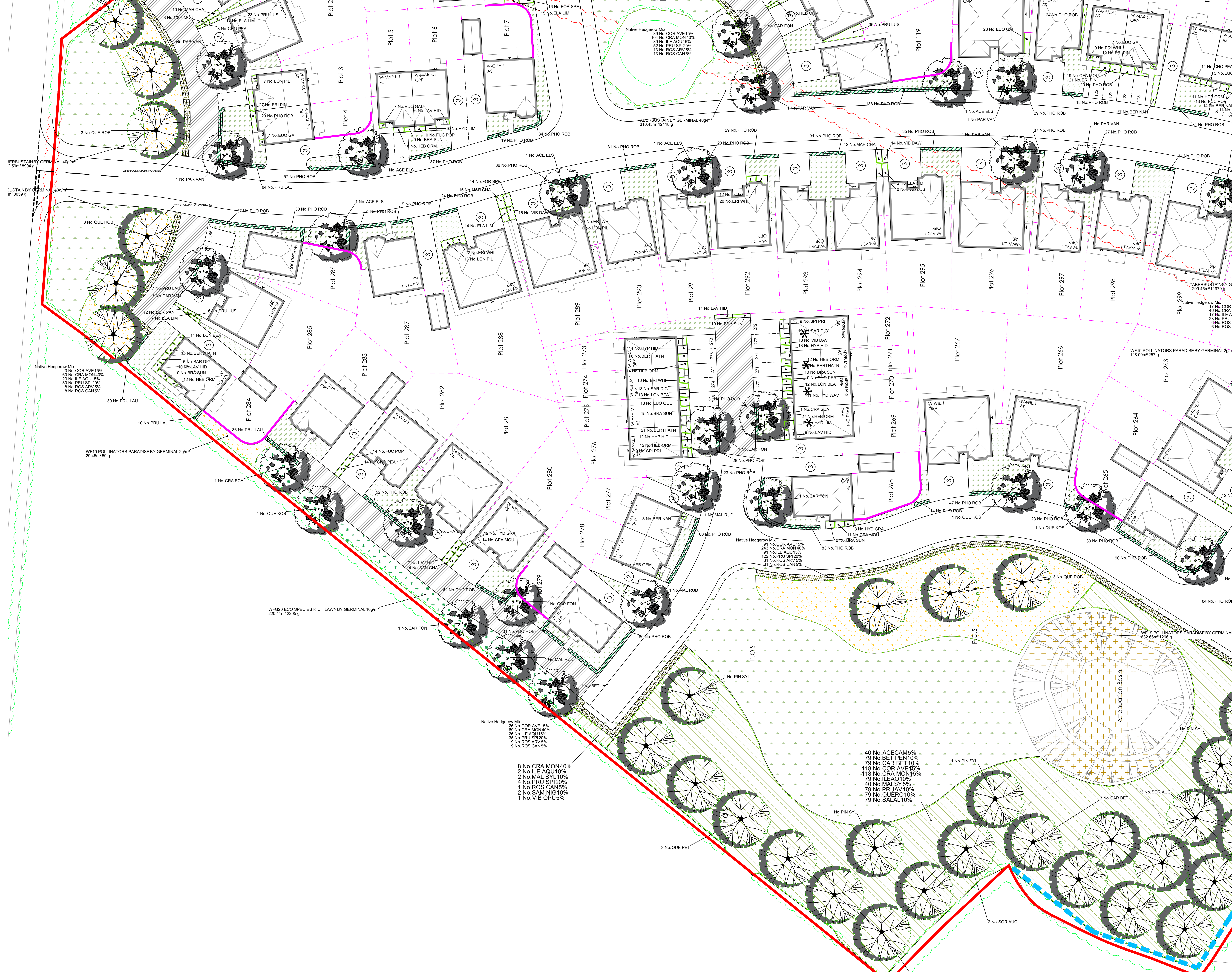

DO NOT SCALE
 ALL COORDINATES RELATED TO LOCAL GRID LOCATED TO OS NO 8 BY BEST FIT TO DETAIL EXTRACTED FROM OS DIGITAL DATA
 © This drawing, including the design and technical information contained on it, is the property of Ascerta. The drawing may only be used for the specific purpose for which it has been intended and may not be reproduced or copied without prior permission.

- Planting Plan Key:**
- Site Boundary
 - Existing trees and hedgerows to be retained and protected during the works.
 - Existing trees and hedgerow to be removed.
 - Proposed ornamental planting on 450mm depth of topsoil with 75mm bark mulch.
 - Proposed native tree planting, tree pit and double staking as detailed in the specification.
 - Proposed ornamental tree planting, tree pit and double staking as detailed in the specification.
 - Proposed mixed native hedgerow planted in a double staggered row at 0.33m centres and 0.3 offset (6 no. plants per linear metre). Bare root transplants (common holly in containers), each with a 60cm high Tubex shrub shelter, two cable ties and a timber stake.
 - Proposed single species formal hedge planted 5 no. plants per linear metre. Container transplants.
 - Front gardens to be turfed with Lindum LT7 Festival Landscape Turf (or similar approved) on 200mm topsoil.
 - Public open space to be sown with Germinal AberSustain mix, or similar approved, to be sown at a rate of 40g/m2 on 200mm topsoil.
 - Public open space to be sown with Germinal Eco Species Rich Lawn mix, or similar approved, to be sown at a rate of 10g/m2 on 200mm topsoil.
 - Native scrub planting to be planted as mainly 60-80cm whip planting at 1m centres, for additional wildlife habitat.
 - Native woodland mix planting to be planted as mainly 60-80cm whip planting at 2m centres, for additional wildlife habitat.
 - Wildflower seeding, Germinal RE3 River Floodplain / Water Meadow (MGB Grassland), to the existing water course within public open space to be sown at 5g/m2 planted into 200mm of a mix of topsoil and subsoil (50:50).
 - Wildflower seeding, WF19 Pollinators Paradise, to the public open space to be sown at 2g/m2 planted into 200mm of a mix of topsoil and subsoil (50:50).

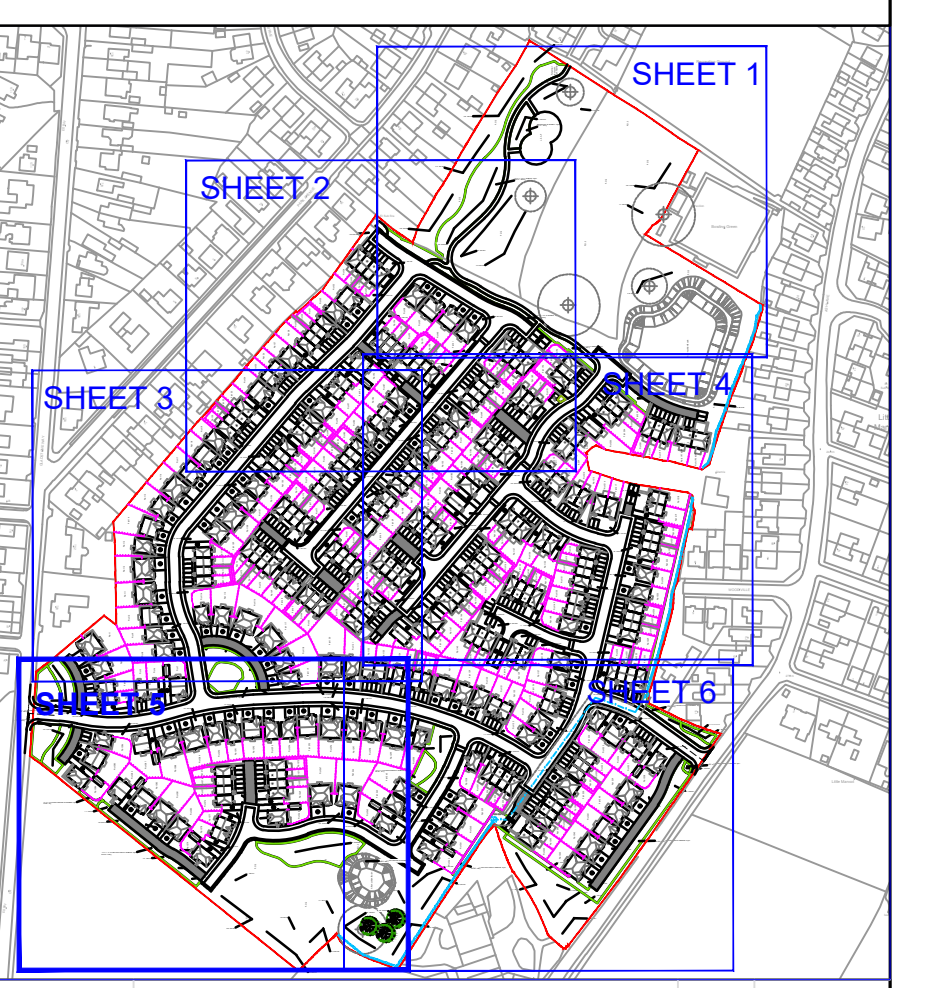
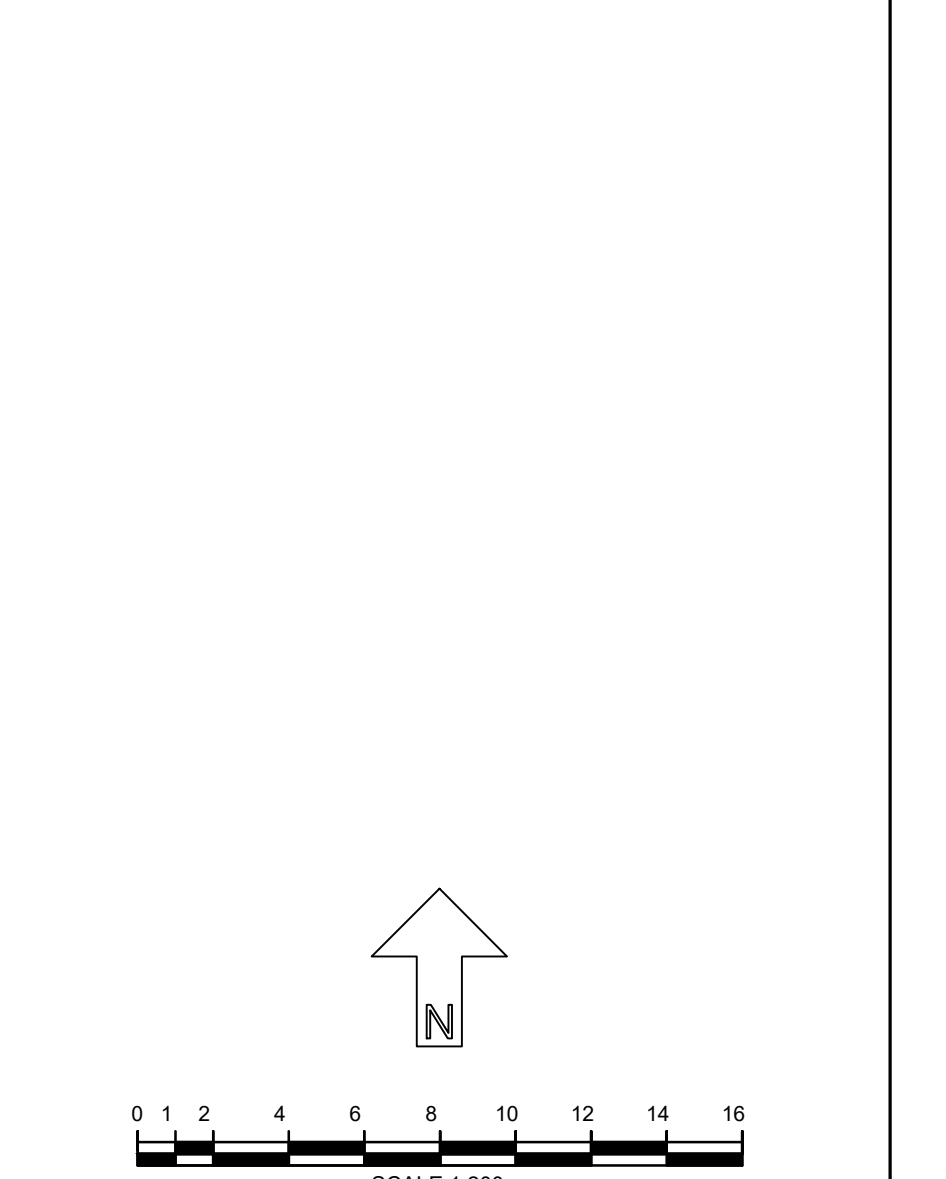

updated to layout "Rev C"	CP 15/1/23
DESCRIPTION	BY DATE

Ascerta
 Landscape | Trees | Ecology
 t: 0845 463 4404
 e: info@landscapetreecology.com
 www.landscapetreecology.com

CLIENT:	Castle Green Homes
PROJECT:	Gladstone Way, Hawarden
DRAWING TITLE:	Planting Plan (Sheet 5 of 6)
SCALE:	1:200 @ A0
DRAWN BY:	CHD
DATE:	19/10/2023
PROJECT NO.:	P.1915.23.04
DATE:	19/10/2023
BY:	A

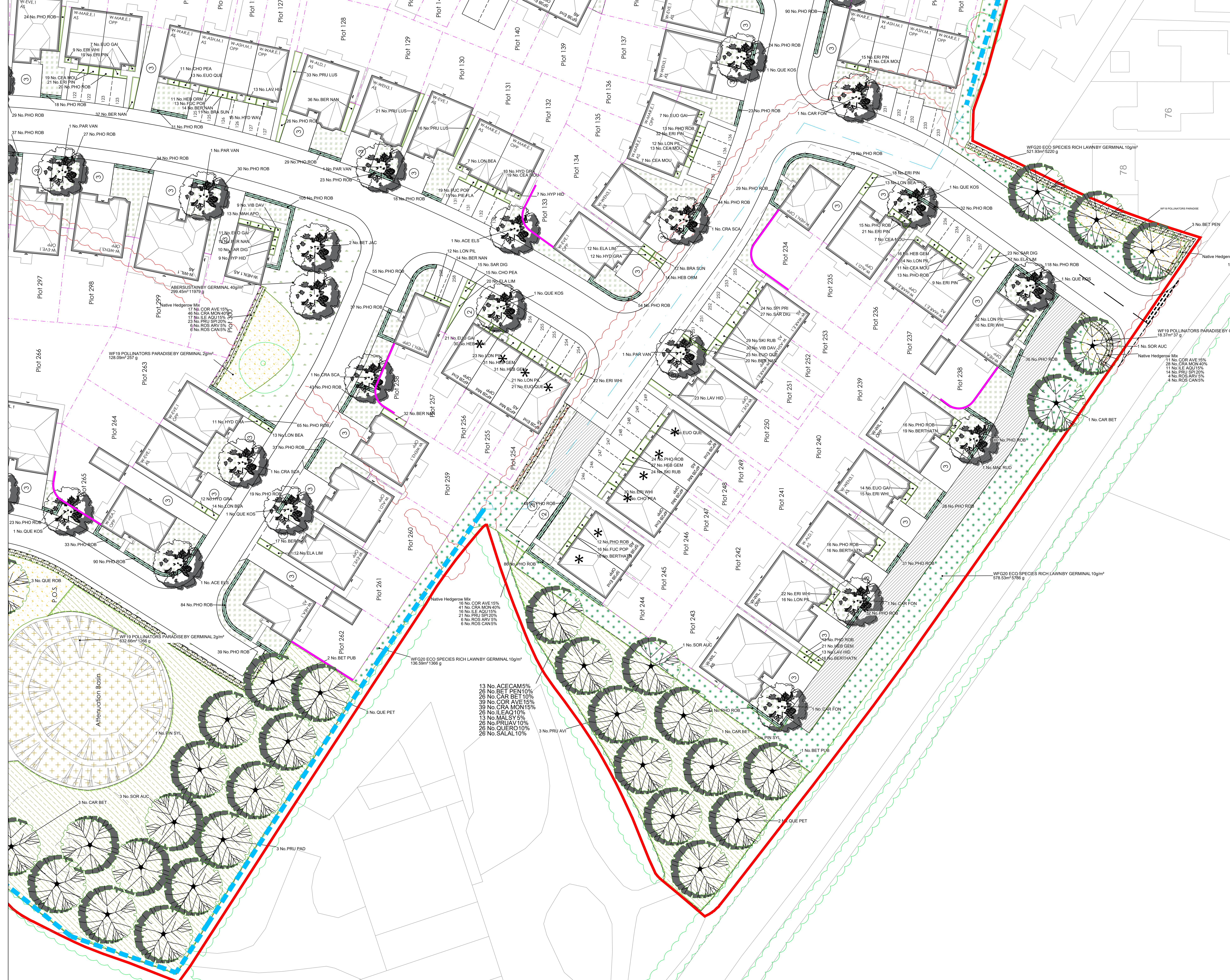

DO NOT SCALE
 ALL COORDINATES RELATED TO LOCAL GRID LOCATED TO OS NO 8 BY BEST FIT TO DETAIL EXTRACTED FROM OS DIGITAL DATA
 © This drawing, including the design and technical information contained on it, is the property of Ascerta. The drawing may only be used for the specific purpose for which it has been intended and may not be reproduced or copied without prior permission.

- Planting Plan Key:**
- Site Boundary
 - Existing trees and hedges to be retained and protected during the works.
 - Existing trees and hedges to be removed.
 - Proposed ornamental planting on 450mm depth of topsoil with 75mm bark mulch.
 - Proposed native tree planting, tree pit and double staking as detailed in the specification.
 - Proposed ornamental tree planting, tree pit and double staking as detailed in the specification.
 - Proposed mixed native hedgerow planted in a double staggered row at 0.33m centres and 0.3 offset (8 no. plants per linear metre). Bare root transplants (common holly in containers), each with a 60cm high Tubex shrub shelter, two cable ties and a timber stake.
 - Proposed single species formal hedge planted 5 no. plants per linear metre. Container transplants.
 - Front gardens to be turfed with Lindum LT7 Festival Landscape Turf (or similar approved) on 200mm topsoil.
 - Public open space to be sown with Germinal AberSustain mix, or similar approved, to be sown at a rate of 40g/m2 on 200mm topsoil.
 - Public open space to be sown with Germinal Eco Species Rich Lawn mix, or similar approved, to be sown at a rate of 10g/m2 on 200mm topsoil.
 - Native scrub planting to be planted as mainly 60-80cm whip planting at 1m centres, for additional wildlife habitat.
 - Native woodland mix planting to be planted as mainly 60-80cm whip planting at 2m centres, for additional wildlife habitat.
 - Willflower seeding, Germinal RE3 River Floodplain / Water Meadow (MGB Grassland), to the existing water course within public open space to be sown at 5g/m2 planted into 200mm of a mix of topsoil and subsoil (50:50).
 - Willflower seeding, WF19 Pollinators Paradise, to the public open space to be sown at 2g/m2 planted into 200mm of a mix of topsoil and subsoil (50:50).

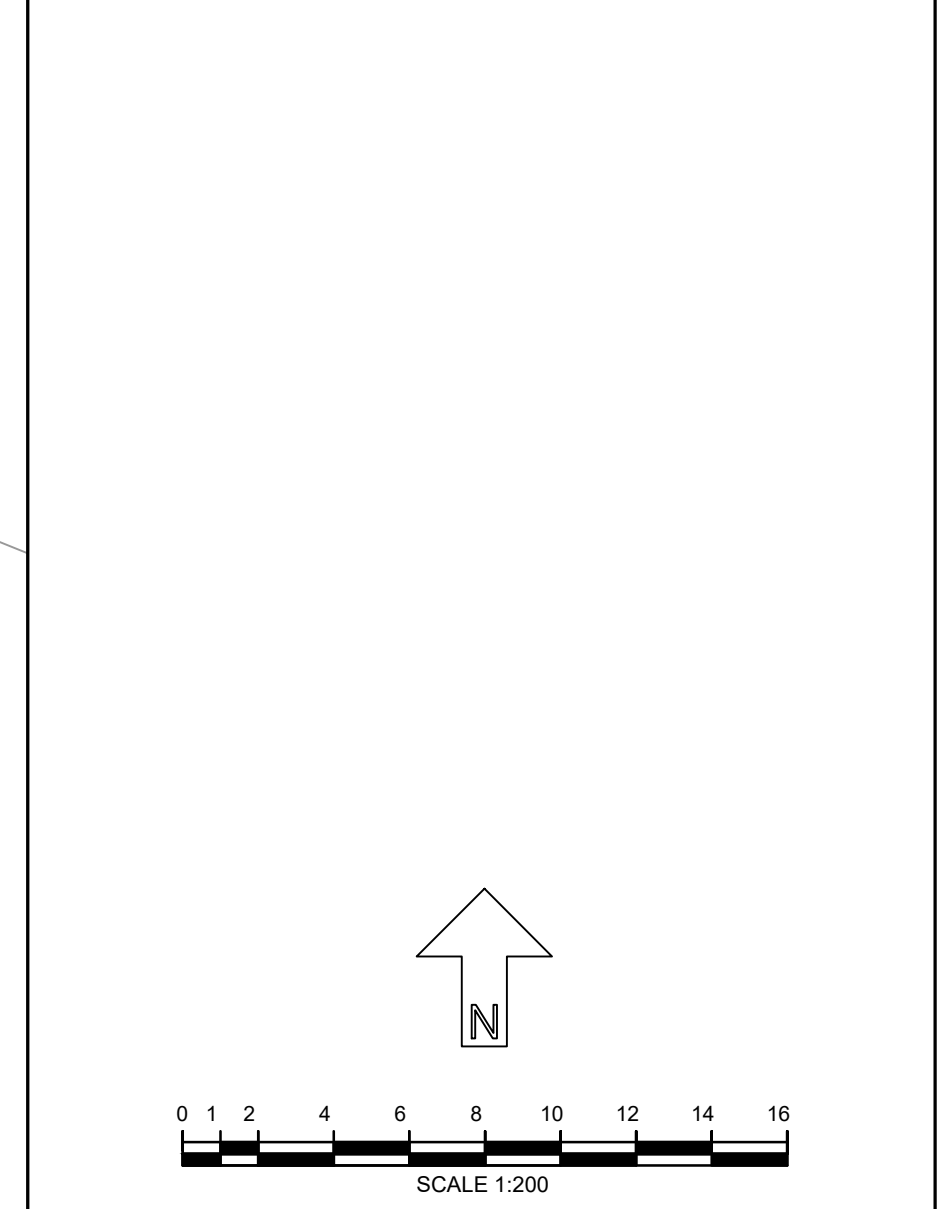

- 13 No. ACE CAM 5%
- 26 No. BET PEN 10%
- 26 No. CAR BET 10%
- 39 No. COR AVE 15%
- 39 No. CRA MON 15%
- 26 No. ILE AQ 10%
- 13 No. MALSY 5%
- 26 No. PRU AV 10%
- 26 No. QUERO 10%
- 26 No. SALAL 10%

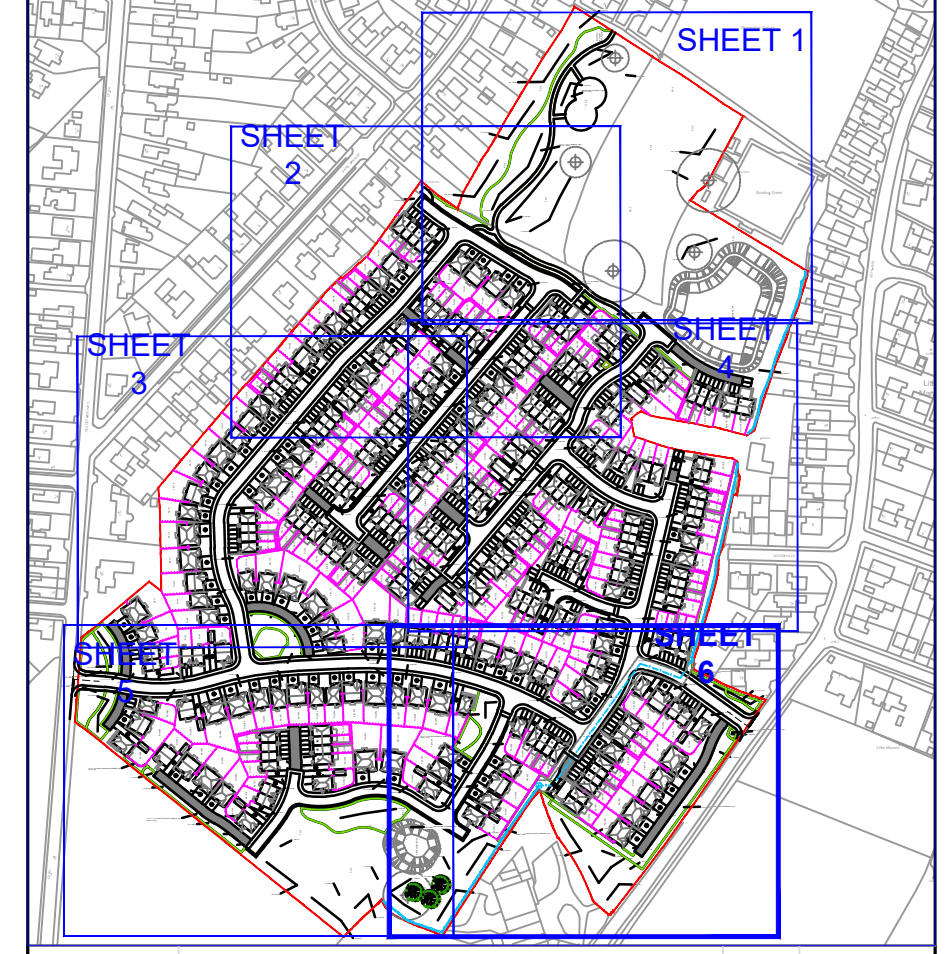

REV	DESCRIPTION	DATE
A	updated to layout "Rev C"	CP 15/11/23

Ascerta
 Landscape | Trees | Ecology
 t: 0845 463 4404
 e: info@landscapetreecology.com
 www.landscapetreecology.com

CLIENT: Castle Green Homes
 PROJECT: Gladstone Way, Hawarden
 DRAWING TITLE: Planting Plan (Sheet 6 of 6)
 SCALE: 1:200 @ A0
 DRAWING No: GJH/CP CN
 DATE: 19/10/2023
 P.1915.23.04
 A

Plant Schedule						
Number of Plants	Abbreviation	Species	Specification	Height	Girth	Density
15 -	ACE ELS	Acer campestre 'Elsrijk'	Selected Standard: 4 brks: 2x: RB: Clear Stem min. 200cm	300-350cm	10-12cm	Counted
11 -	BET PEN	Betula pendula	Heavy Standard: 5 brks: 3x: RB: Clear Stem 175-200cm	350-425cm	12-14cm	Counted
4 -	BET PUB	Betula pubescens	Heavy Standard: 5 brks: 3x: RB: Clear Stem 175-200cm	350-425cm	12-14cm	Counted
7 -	BET JAC	Betula utilis jacquemontii	Selected Standard: 5 brks: 2x: RB: Clear Stem 175-200cm	300-350cm	10-12cm	Counted
10 -	CAR BET	Carpinus betulus	Heavy Standard: 5 brks: 3x: RB: Clear Stem 175-200cm	350-425cm	12-14cm	Counted
16 -	CAR FON	Carpinus betulus 'Frans Fontaine'	Selected Standard: 4 brks: 2x: RB: Clear Stem 175-200cm	300-350cm	10-12cm	Counted
9 -	CRA SCA	Crataegus laevigata 'Paul's Scarlet'	Selected Standard: 4 brks: 2x: RB: Clear Stem 175-200cm	300-350cm	10-12cm	Counted
18 -	MAL RUD	Malus 'Rudolph'	Selected Standard: 4 brks: 2x: RB: Clear Stem 175-200cm	300-350cm	10-12cm	Counted
13 -	PAR VAN	Parrotia persica 'Vanessa'	Selected Standard: 4 brks: 2x: RB: Clear Stem 175-200cm	300-350cm	10-12cm	Counted
7 -	PIN SYL	Pinus sylvestris	Leader with Lateralis: Feathered to base: 5x: RB	350-400cm		Counted
7 -	PRU AVI	Prunus avium	Heavy Standard: 5 brks: 3x: RB: Clear Stem 175-200cm	350-425cm	12-14cm	Counted
7 -	PRU PAD	Prunus padus	Heavy Standard: 5 brks: 3x: RB: Clear Stem 175-200cm	350-425cm	12-14cm	Counted
11 -	QUE PET	Quercus petraea	Heavy Standard: 5 brks: 3x: RB: Clear Stem 175-200cm	350-425cm	12-14cm	Counted
15 -	QUE ROB	Quercus robur	Heavy Standard: 5 brks: 3x: RB: Clear Stem 175-200cm	350-425cm	12-14cm	Counted
19 -	QUE ROS	Quercus robur 'Fastigiata Koster'	Selected Standard: 4 brks: 2x: RB: Clear Stem 175-200cm	300-350cm	10-12cm	Counted
9 -	SOR AUC	Sorbus aucuparia	Heavy Standard: 5 brks: 3x: RB: Clear Stem 175-200cm	350-425cm	12-14cm	Counted
Total :178 -						

Shrubs								
Number of Plants	Abbreviation	Species	Specification	Height	Diameter	Pot Size	Density	Area
916 -	BER NAN	Berberis buxifolia 'Nana'	Bushy: 4 brks: C	20-30cm		3L	7/m ²	128,164m ²
218 -	BERTHATN	Berberis thunbergii 'Atropurpurea Nana'	Branched: 4 brks: C	20-25cm		3L	7/m ²	30,3625m ²
165 -	BRASUN	Brachyglottis 'Sunshine'	Branched: 4 brks: C	30-40cm		3L	5/m ²	31,5936m ²
529 -	CEA MOU	Ceanothus 'Blue Mound'	Branched: 5 brks: C		30-40cm	3L	6/m ²	85,2014m ²
148 -	CHO PEA	Choisya 'Aztec Pearl'	Bushy: 5 brks: C	30-40cm		3L	6/m ²	23,8007m ²
122 -	CIS PIN	Cistus 'Silver Pink'	Bushy: 4 brks: C	20-30cm		3L	6/m ²	19,5966m ²
196 -	ELA LIM	Elaeagnus x ebbingei 'Limelight'	Branched: 3 brks: C	30-40cm		3L	5/m ²	38,0675m ²
762 -	ERI PIN	Erica carnea 'Springwood Pink'	Bushy: C			3L	8/m ²	92,8397m ²
209 -	ERI WHI	Erica carnea 'Springwood White'	Bushy: C			3L	8/m ²	25,329m ²
1090 -	EUI GAI	Euonymus fortunei 'Emerald Gaiety'	Bushy: 7 brks: C	20-30cm	20-30cm	3L	6/m ²	176,053m ²
305 -	EUI QUE	Euonymus fortunei 'Silver Queen'	Bushy: 5 brks: C	20-30cm	20-30cm	3L	7/m ²	42,5487m ²
135 -	FOR SPE	Forsythia x intermedia 'Spectabilis'	Branched: 3 brks: C	60-80cm		3L	5/m ²	26,2049m ²
224 -	FUC POP	Fuchsia 'Mrs Popple'	Bushy: 5 brks: C	20-30cm		3L	6/m ²	36,4117m ²
250 -	HEB ORM	Hebe 'Great Orme'	Bushy: 3 brks: C	30-40cm		3L	6/m ²	40,4539m ²
166 -	HEB GEM	Hebe 'Green Globe'	Bushy: 7 brks: C	15-20cm		3L	9/m ²	17,9435m ²
91 -	HEB WIN	Hebe 'Mrs Winder'	Bushy: 5 brks: C	30-40cm		3L	6/m ²	14,5625m ²
120 -	HYD WAV	Hydrangea macrophylla 'Blue Wave'	Branched: 5 brks: C	40-60cm		5L	5/m ²	23,0285m ²
116 -	HYD GRA	Hydrangea paniculata 'Grandiflora'	Branched: 3 brks: C	30-40cm		2L	5/m ²	22,0445m ²
110 -	HYD LIM	Hydrangea paniculata 'Little Lime'	Branched: 3 brks: C	30-40cm		3L	6/m ²	16,3942m ²
181 -	HYP HID	Hypericum 'Hidcote'	Bushy: 5 brks: C	30-40cm		3L	6/m ²	29,1465m ²
173 -	LAV HID	Lavandula angustifolia 'Hidcote'	Bushy: 5 brks: C	20-30cm		3L	5/m ²	32,7529m ²
191 -	LON BEA	Lonicera nitida 'Lemon Beauty'	Bushy: 5 brks: C		30-40cm	3L	6/m ²	30,5785m ²
863 -	LON PIL	Lonicera pileata	Bushy: 6 brks: C		30-40cm	3L	6/m ²	139,8628m ²
26 -	MAH APO	Mahonia aquifolium 'Apollo'	Branched: 2 brks: C	20-30cm		3L	7/m ²	3,5203m ²
37 -	MAH CHA	Mahonia x media 'Charity'	Bushy: 2 brks: C	30-40cm		3L	5/m ²	6,9679m ²
820 -	PHO ROB	Phloxia x fraseri 'Red Robin'	Branched: 6 brks: C	30-40cm		3L	6/m ²	132,9281m ²
68 -	PIE FLA	Pieris 'Forest Flame'	Bushy: 3 brks: C	30-40cm		3L	6/m ²	11,0443m ²
319 -	PRU LUS	Prunus lusitanica	Bushy: 4 brks: C	30-40cm		3L	4/m ²	77,8882m ²
59 -	SAN CHA	Santolina chamaecyparissus	Bushy: 7 brks: C	20-30cm		3L	6/m ²	9,5544m ²
287 -	SAR DIG	Sarcococca hookeriana digyna	Bushy: 6 brks: C	20-30cm		3L	7/m ²	39,8493m ²
248 -	SKI RUB	Skimmia japonica 'Rubella'	Bushy: 3 brks: C	30-40cm		3L	7/m ²	34,7599m ²
119 -	SPI PRN	Spiraea japonica 'Little Princess'	Bushy: 5 brks: C	20-30cm		2L	7/m ²	16,5279m ²
98 -	VIB DAV	Viburnum davidii	Bushy: 3 brks: C	30-40cm		3L	6/m ²	15,7819m ²
46 -	VIB DAW	Viburnum x bodnantense 'Dawn'	Branched: 2 brks: C	40-60cm		3L	6/m ²	7,5466m ²
79 -	WEI RUB	Weigela 'Bristol Ruby'	Branched: 4 brks: C	40-60cm		3L	5/m ²	15,445m ²
Total :9477 -								Total :1494,7561m ²

Formal Hedge							
Number	Abbreviation	Species	Specification	Height	Pot Size	Density	Length
5684 -	PHO ROB	Phloxia x fraseri 'Red Robin'	Branched: 3 brks: C	20-30cm	2L	5/m	1123,2673m
177 -	PRU LAU	Prunus laurocerasus	Bushy: 3 brks: C	40-60cm	2L	5/m	34,9026m
Total :5861 -							Total :1158,1699m

Grass and Wildflower Areas				
Weight	Seed Mix Name	Seed Mix Supplier	Density	Area
109197 g	ABERSUSTAIN	BY GERMINAL	40g/m ²	2729,7917m ²
2527 g	WF19 POLLINATORS PARADISE	BY GERMINAL	2g/m ²	1261,8567m ²
14577 g	WFG20 ECO SPECIES RICH LAWN	BY GERMINAL	10g/m ²	1457,4568m ²
Total :126301				Total :5449,1052m ²

Native Hedgerow Mix								
Number	Abbreviation	Species	Specification	Height	Pot Size	Density	Percentage Contribution	Length
462 -	COR AVE	Corylus avellana	1+2: Transplant - seed raised: Branched: 3 brks: B	60-80cm		0.33Ctr Double Staggered at 0.3m offset	15%	74,9492m
1219 -	CRA MON	Crataegus monogyna	1+1: Transplant - seed raised: B	60-80cm		0.33Ctr Double Staggered at 0.3m offset	40%	199,8647m
462 -	ILE AQU	Ilex aquifolium	Leader with Lateralis: C	40-60cm	3L	0.33Ctr Double Staggered at 0.3m offset	15%	74,9492m
614 -	PRU SPI	Prunus spinosa	1+1: Transplant - seed raised: Branched: 2 brks: B	60-80cm		0.33Ctr Double Staggered at 0.3m offset	20%	99,9326m
160 -	ROS ARV	Rosa arvensis	1+1: Transplant - seed raised: Branched: 2 brks: B	60-80cm		0.33Ctr Double Staggered at 0.3m offset	5%	24,9831m
160 -	ROS CAN	Rosa canina	1+1: Transplant - seed raised: Branched: 3 brks: B	60-80cm		0.33Ctr Double Staggered at 0.3m offset	5%	24,9831m
Total :3077 -								Total :499,6619m

Native Scrub Mix								
Number	Abbreviation	Species	Specification	Height	Pot Size	Density	Percentage Contribution	Area
475 -	CRA MON	Crataegus monogyna	1+1: Transplant - seed raised: B	60-80cm		1Ctr	40%	472,2493m ²
120 -	ILE AQU	Ilex aquifolium	Bushy: 3 brks: C	40-60cm	3L	1Ctr	10%	118,0623m ²
120 -	MAL SYL	Malus sylvestris	1+1: Transplant - seed raised: B	60-80cm		1Ctr	10%	118,0623m ²
238 -	PRU SPI	Prunus spinosa	1+1: Transplant - seed raised: Branched: 2 brks: B	60-80cm		1Ctr	20%	236,1248m ²
60 -	ROS CAN	Rosa canina	1+1: Transplant - seed raised: Branched: 3 brks: B	60-80cm		1Ctr	5%	59,0311m ²
120 -	SAM NIG	Sambucus nigra	1+1: Transplant - seed raised: Branched: 3 brks: B	60-80cm		1Ctr	10%	118,0623m ²
60 -	VIB OPU	Viburnum opulus	1+2: Transplant - seed raised: Branched: 3 brks: B	60-80cm		1Ctr	5%	59,0311m ²
Total :1193 -								Total :1180,6232m ²

Proposed Mixed Woodland Planting								
Number	Abbreviation	Species	Specification	Height	Pot Size	Density	Percentage Contribution	Area
67 -	ACECAM	Acer campestre	1+1: Transplant - seed raised: B	60-80cm		2Ctr	5%	261,3988m ²
133 -	BET PEN	Betula pendula	1+1: Transplant - seed raised: B	60-80cm		2Ctr	10%	522,7977m ²
133 -	CAR BET	Carpinus betulus	1+1: Transplant - seed raised: B	60-80cm		2Ctr	10%	522,7977m ²
198 -	COR AVE	Corylus avellana	1+2: Transplant - seed raised: 3brks: B	60-80cm		2Ctr	15%	784,1966m ²
198 -	CRA MON	Crataegus monogyna	1+1: Transplant - seed raised: B	60-80cm		2Ctr	15%	784,1966m ²
133 -	ILEAO	Ilex aquifolium	Bushy: 3 brks: C	40-60cm	3L	2Ctr	10%	522,7977m ²
67 -	MALSY	Malus sylvestris	1+1: Transplant - seed raised: B	60-80cm		2Ctr	5%	261,3988m ²
133 -	PRUAV	Prunus avium	1+1: Transplant - seed raised: B	60-80cm		2Ctr	10%	522,7977m ²
133 -	QUERO	Quercus robur	1+1: Transplant - seed raised: B	60-80cm		2Ctr	10%	522,7977m ²
133 -	SALAL	Salix alba	1+1: Transplant - seed raised: B	60-80cm		2Ctr	10%	522,7977m ²
Total :1328 -								Total :5227,977m ²

LANDSCAPE AND MAINTENANCE SPECIFICATION

All operations to comply with appropriate British Standards unless otherwise stated on drawings or in the specification.

GENERAL TREATMENT OF PLANTING AREAS

Ensure that planting areas are protected from consolidation by heavy construction plant.

For work near a retained tree: Refer to BS 5637 *Trees in relation to design, demolition & construction - Recommendations-* Section 9 (Appendix C).

Damage to Plants to be Retained: If a plant is to be retained is damaged, the plant is to be repaired or replaced by the contractor at their own expense. 'Damaged' means:

- The destruction of a plant the breaking of branches or roots
- The debarking of trunks or limbs
- The contamination of root zone soil or plants from drift sprays, dust or contaminated storm water
- The damage by the placement of fill or building materials within the canopy perimeter or otherwise.

1) GROUND PREPARATION AND SOIL SPECIFICATION

Subsoil:

Before receiving topsoil, subsoil shall be loosened using appropriate equipment to a depth of 300mm. This shall be done when the subsoil is dry so as to encourage soil shattering. All stones and other objects larger than 50mm shall be removed from the prepared surface. The loosened subsoil shall be roughly levelled so that an even depth of topsoil can be achieved.

Topsoil (To Comply with British Standard 3882:2015 - Specification for Topsoil):

Imported topsoil shall be Multipurpose Grade as described in BS 3882:2015 and suitable for sustaining plant life. Stockpiling of soil shall be avoided whenever possible to minimise loss of physical quality, diffusion of oxygen and biological activity. Any stockpiling shall not exceed 1.5 metres high and shall be sited so as to avoid risk of muddy water run-off into a watercourse, not exceeding 1.5 metres high.

The site of the stockpile will be prepared in advance by grading, removing rubbish and ensuring no fuel or chemicals were previously stored in area.

Topsoil shall be lightly consolidated in layers not exceeding 150mm using track laying machinery.

Soil shall not be handled in inappropriate conditions of weather and soil moisture i.e.

During or shortly after heavy precipitation

When soil is in a waterlogged condition

When the ground is frozen or covered by snow

When there are pools of water on the grounds surface.

Topsoil shall be laid to the following minimum depths:

- 200mm below new grass areas

- 300mm to rear gardens

- 450mm beneath new shrub areas

- For wildflower areas a mixture of topsoil and selected subsoil (about 50:50) for a depth of about 150 mm. Selected subsoil alone can be used but if the structure is poor and the fertility very low there will be a very slow establishment of wildflowers and frequently domination by plants such as clovers which do not depend on nitrogen in the soil for their growth.

Finished levels, after settlement, shall be as follows.

25mm above adjacent paving from new grassed areas and non-mulched shrub beds

75mm below adjacent paving and grass for mulched planting beds.

150mm below damp proof courses.

2) GROUND CONDITIONING

40 litres of compost to be incorporated into the top 200mm of each square metre of topsoil for all ornamental shrub beds.

3) PLANT AND PLANTING SPECIFICATION

All plant stock, plant handling and planting to be undertaken in accordance with the following British Standard Specifications and Code of Practice:

BS 8545:2014 'Trees: from nursery to independence in the landscape

BS 3936: Part 1 1992 Nursery stock (Specification for trees and shrubs)

BS 3936: Part 4 1984 Nursery stock (Specification for forest trees)

BS 3936: Part 9 1987 Nursery stock (Specification for bulbs, corms and tubers)

BS 3936: Part 10 1980 Nursery stock (Specification for ground cover plants)

BS 4428: 1989 Recommendations for general landscaping operations.

BS 4043: 1989 Recommendations for transplanting root-balled trees, (withdrawn)

The Code of Practice for Plant Handling 1985. (Horticultural Trades Association).