

N 363560	E 326690
N 363540	E 326700
N 363520	E 326710
N 363500	E 326720
N 363480	E 326730
N 363460	E 326740
N 363440	E 326750
N 363420	E 326760

- ### NOTES
1. SURVEY CONTROL:
 1.1 SURVEY CONTROL POINTS:
 THIS SURVEY IS ORIENTATED TO ORDNANCE SURVEY GRID NORTH. THE SURVEY TO
 A BOUNDARY POINTS (OR MOUNTAIN) MEASUREMENTS TAKEN FROM THIS SURVEY WILL BE
 FULL ORDNANCE SURVEY COORDINATES CAN BE CALCULATED BY SCALING THE
 SURVEY POINTS TO THE SITE CENTRE WITH COORDINATES SURVEYED IN THESE 00
 POINT. NOT REQUIRED.
 SCALE: 1:50 000
 POSITION: NOT REQUIRED.
 THE LOCAL SCALE FACTOR IS APPLICABLE TO THIS SITE IS 0.9997. CALCULATED
 SURVEY COORDINATES ARE THE ACTIVE ORDNANCE SURVEY COORDINATES.
 FOR THIS RELATIVELY LOW LEVEL SITE, MEAN SEA LEVEL CORRECTIONS WILL BE
 DEEMED TO BE SIGNIFICANT AND HAVE THEREFORE NOT BEEN APPLIED.
 1.2 VERTICAL CONTROL:
 ALTIMETERS FOR THE CONTROL HAVE BEEN CALCULATED FROM GPS DERIVED
 HEIGHTS AND CONVERTED TO ORDNANCE HEIGHTS (ORDNANCE DATUM MEAN
 SEA LEVEL) USING TRANSFORMATION PARAMETERS.
 THE CO-ORDINATE SYSTEMS USED FOR THE PRIMARY CONTROL IS OSGM02. THIS HAS
 BEEN CALCULATED FROM ETRS89 USING OSGM02 TRANSFORMATION PARAMETERS.
 METHOD FOR THIS PARTICULAR PROJECT: THE TRIMBLE AND BENTLEY NETWORK HAS
 BEEN USED. OBSERVATIONS WERE TAKEN ON THE FOLLOWING DATE: 05/05/16
 WHEN THE FOLLOWING ACCURACY WAS ACHIEVED: E: 10.0mm, N: 20.0mm, V: 30.0mm.
 MEAN POINTS LISTED ACCORDING TO: E: 10.0mm, N: 20.0mm, V: 30.0mm.
 THE CONTROL SYSTEMS USED FOR THIS PROJECT ARE THE TRIMBLE AND BENTLEY NETWORK
 WHERE POSSIBLE AND PRACTICAL. TOWER SURVEYS HAVE USED AN OPEN BOX
 WITH GOOD QUALITY SENSORS IN ORDER TO MAINTAIN THE HIGHEST ACCURACY
 POSSIBLE.
 THIS DRAWING IS TO BE READ IN CONJUNCTION WITH ALL OTHER RELEVANT
 DRAWINGS AND DOCUMENTATION.
 1.3 SCALE: SCALE 1:500. SCALE SHOULD BE USED TO DETERMINE DIMENSIONS
 FROM THIS DRAWING.
 4. IF IN DOUBT ASK.

- ### LEGEND
- SPOT LEVEL
 - SURVEY STATION
 - BURIES
 - BOUNDARY OF UNDERGROUND
 - TREE (INDICATIVE ONLY)
 - BUILDING
 - CONTOUR
 - RETAINING WALL
 - BANKING
 - GATE
 - OVERHEAD CABLE
 - FENCE WITH SUBSCRIPTION
 - OPEN DRAINAGE
 - HT AND MESS
 - IRON PIPE
 - POST AND WIRE
 - PIPE
 - POST AND STRING
 - WIRE
- ### ABBREVIATIONS
- | | | | |
|------|--------------------|-----|-----------------|
| AVR | AREA ROOF LEVEL | LB | LETTER BOX |
| B | BOLARD | LP | LAMP POST |
| BR | BELLEVUE BRACKEN | MBR | MANHOLE POST |
| BZ | BENCH LEVEL | MB | MANHOLE |
| BP | BOUNDARY POST | MSS | MANHOLE SQUARE |
| BT | BUTTON | MPT | MANHOLE TROUSLE |
| CCTV | CABLE TELEVISION C | MP | MANHOLE |
| CS | CONCRETE | MSP | MANHOLE |
| DL | COVER LEVEL | MP | MANHOLE |
| DL | COVER LEVEL | MP | MANHOLE |
| DL | COVER LEVEL | MP | MANHOLE |

STATION CO-ORDINATES

STATION	EASTING	NORTHING	LEVEL	DESCRIPTION
STN01	326803.51	363875.77	157.54	SURVEY NAIL
STN02	326810.51	363881.10	158.27	POST AND NAIL
STN03	326807.14	363838.41	151.15	POST AND NAIL
STN04	326804.84	363833.84	152.33	SURVEY NAIL
STN05	326789.89	363840.01	147.89	SURVEY NAIL
STN06	326844.64	363833.84	158.27	SURVEY NAIL
STN07	326848.45	363778.25	158.46	SURVEY NAIL
STN08	326866.84	363866.80	152.33	SURVEY NAIL
STN09	326868.45	363868.45	158.27	SURVEY NAIL

UNLESS OTHERWISE STATED THE SURVEY STATIONS LISTED ABOVE ARE ONLY
 INTENDED TO BE USED FOR TOPOGRAPHICAL SURVEYS AT THE STATED SCALE
 DUE CONSIDERATION SHOULD BE GIVEN TO LONG TERM STABILITY OF SURVEY STATION
 MARKERS

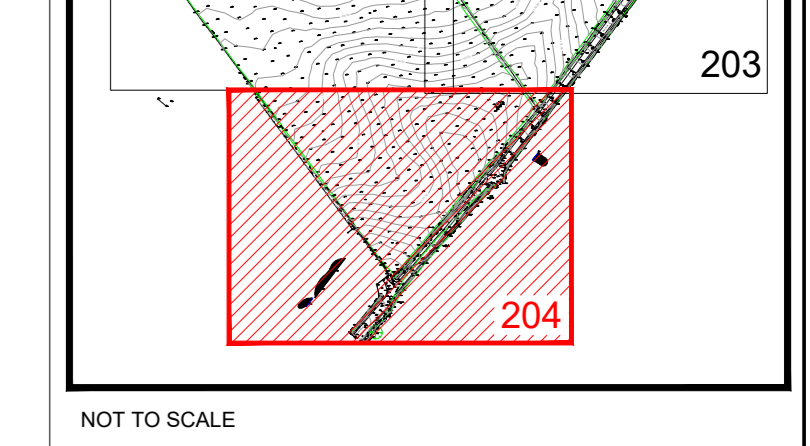

- NOT TO SCALE
- ### GENERAL
- NO ALLOWANCE HAS BEEN MADE FOR SUB-SURFACE ENTRY INTO MANHOLES OR OTHER
 OPENINGS OF LOCAL BUILT LEVELS. THEREFORE ANY OPENINGS RELATING TO
 DEPths ETC ARE TAKEN FROM ABOVE GROUND AND AS SUCH WILL BE APPROXIMATE
 TO THE ACTUAL.
 - CONSTRUCTION CONTRACTORS SHOULD VERIFY ALL DEPTHS, DIMENSIONS AND LEVELS BEFORE
 BEGINS WORK. CHECK AND IDENTIFY ALL DEPTHS, DIMENSIONS AND LEVELS BEFORE
 BEGINS WORK. CHECK AND IDENTIFY ALL DEPTHS, DIMENSIONS AND LEVELS BEFORE
 BEGINS WORK. CHECK AND IDENTIFY ALL DEPTHS, DIMENSIONS AND LEVELS BEFORE
 BEGINS WORK. CHECK AND IDENTIFY ALL DEPTHS, DIMENSIONS AND LEVELS BEFORE
 BEGINS WORK.
 - CONSTRUCTION CONTRACTORS SHOULD VERIFY ALL DEPTHS, DIMENSIONS AND LEVELS BEFORE
 BEGINS WORK. CHECK AND IDENTIFY ALL DEPTHS, DIMENSIONS AND LEVELS BEFORE
 BEGINS WORK. CHECK AND IDENTIFY ALL DEPTHS, DIMENSIONS AND LEVELS BEFORE
 BEGINS WORK. CHECK AND IDENTIFY ALL DEPTHS, DIMENSIONS AND LEVELS BEFORE
 BEGINS WORK.
 - IT IS IMPORTANT TO NOTE THAT THE SAME ACCURACIES SHOWN BY THE PLOTTING SCALE
 APPLY TO ALL DIMENSIONS AND LEVELS. DIMENSIONS AND LEVELS SHOULD BE
 CHECKED AGAINST THE ORIGINAL DATA AND NOT JUST THE PLOTTING SCALE.
 - IF ANY DIMENSIONS OR LEVELS ARE SHOWN WITHIN THE PLOTTING SCALE AND THE
 ORIGINAL DATA ARE SHOWN TO BE DIFFERENT, THE ORIGINAL DATA SHOULD BE
 USED. DIMENSIONS AND LEVELS SHOULD BE CHECKED AGAINST THE ORIGINAL DATA
 AND NOT JUST THE PLOTTING SCALE.
 - IT IS IMPORTANT TO NOTE THAT THE SAME ACCURACIES SHOWN BY THE PLOTTING SCALE
 APPLY TO ALL DIMENSIONS AND LEVELS. DIMENSIONS AND LEVELS SHOULD BE
 CHECKED AGAINST THE ORIGINAL DATA AND NOT JUST THE PLOTTING SCALE.

DESCRIPTION STATUS

DESCRIPTION	REV	DATE	CHKD	APPR

INFORMATION

Tower Surveys Ltd
 1 LYME DRIVE
 SOUTHWEAST
 EXETER EX4 0PB
 TEL: 44 (0)1392 867676
 FAX: 44 (0)1392 867671
 www.towersurveys.co.uk

RICS
 Registered by RICS

CLIENT
OPUS INTERNATIONAL CONSULTANTS

PROJECT TITLE
**WELL STREET, BUCKLEY
 FLINTSHIRE**

DRAWING DETAIL
**TOPOGRAPHICAL SURVEY AS OF 04/05/16
 SHEET 4 OF 4**

DRAWN	DT	DATE	MAY 2016
PROJECT ENGINEER	PV	SCALE	1:200 (WHEN PLOTTED @ A0)
CHECKED	ML	REVISION	
APPROVED	AC	DRAWING NUMBER	R-11799/204