



Potential footpath link

Post

St Kentigern  
Hospice

- DO NOT SCALE**
- ALL COORDINATES RELATED TO LOCAL GRID LOCATED TO OS NG BY BEST FIT TO DETAIL, EXTRACTED FROM OS DIGITAL DATA.
- © This drawing, including the design and technical information contained on it, is the property of Ascerta. The drawing may only be used for the specific purpose for which it has been intended and may not be reproduced or copied without prior permission.
- Planting Plan Key:**
- Site Boundary
  - Existing trees and vegetation to be retained and protected during the works.
  - Existing trees and vegetation to be removed.
  - Proposed ornamental planting on 400mm depth of topsoil with 75mm bark mulch.
  - Proposed native tree planting, tree pit and double staking as detailed in the specification.
  - Proposed ornamental tree planting, tree pit and double staking as detailed in the specification.
  - Proposed mixed native hedgerow planted in a double staggered row at 0.33m centres and 0.3 offset (0 no. plants per linear metre). Bare root transplants (common holly in containers), each with a 60cm high Tubes shrub shelter, two cable ties and a timber stake.
  - Proposed single species formal hedge planted in a single row at 3 no. plants per linear metre. Container transplants.
  - Front gardens to be turfed on 150mm topsoil.
  - Public open space to be sown with Geminal AberSustain mix, or similar approved, to be sown at a rate of 40g/m2 on 150mm topsoil.
  - Native scrub planting to be planted as 60-80cm whip planting at 1m centres, for additional wildlife habitat.
  - Native woodland planting to be planted as 60-80cm whip planting at 2m centres, for additional wildlife habitat.

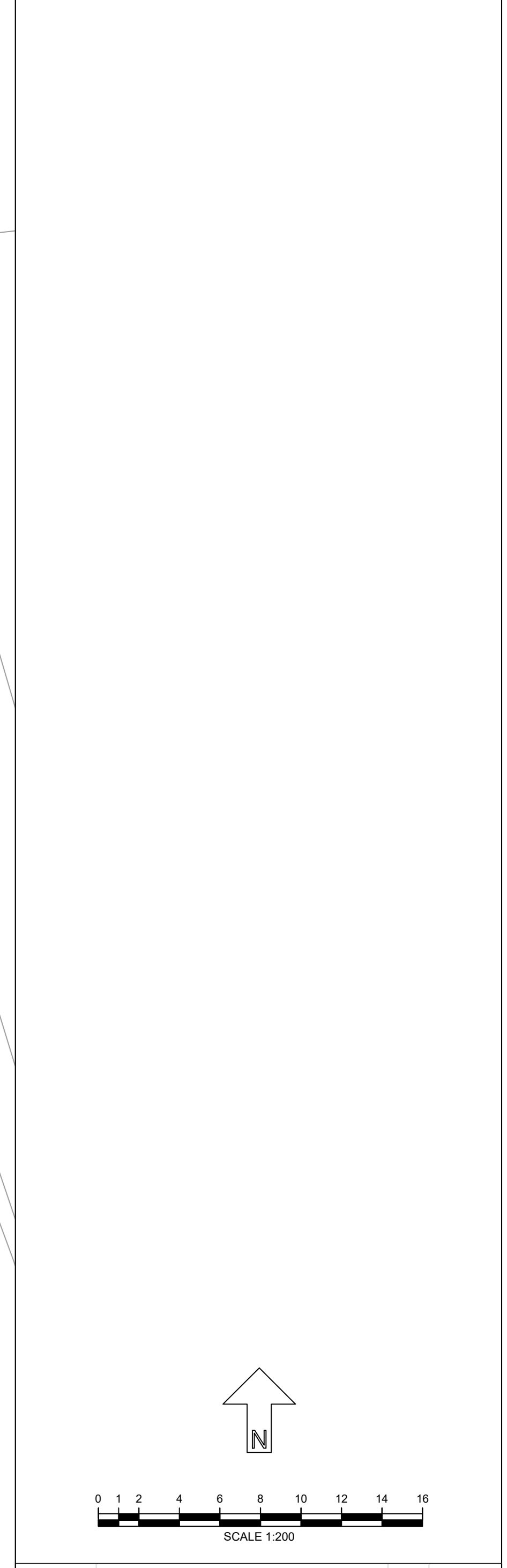

A	Minor Amendments	CN	17/01/23
REV	DESCRIPTION	BY	DATE
<b>Ascerta</b> Landscape   Trees   Ecology			
t: 0845 463 4404 e: info@landscapetreecology.com www.landscapetreecology.com			
CLIENT: Castle Green Homes			
PROJECT: Former Ambulance Centre, St. Asaph			
DRAWING TITLE: Planting Plan			
SCALE: 1:200 @ A0	DRAWING No:	REV:	
DRAWN BY: AC	CHKD BY: CN	DATE: 16/01/2023	P.1766.23.04

