

**GENERAL NOTES**

- This drawing is the copyright of tpm landscape Ltd and cannot be reproduced in any form without the consent of the company.
- This drawing is to be read in conjunction with detail landscape drawings, details and specification.
- This drawing is to be read in conjunction with all relevant Architects', Engineer's, Specialists, Bills of Quantities and Specifications.
- The insertion of any firm or proprietary brand on this drawing is an indication of the class or quality required and does not exclude the use of alternative materials that are equal in performance, quality and appearance, provided that they have been approved in writing by the Landscape Architect.
- The Contractor is responsible for accurately ascertaining the position of underground services and responding to all relevant service easement requirements.
- All dimensions are in millimetres unless stated otherwise, for the purposes of construction this drawing must not be scaled and only written dimensions used. Written and scaled dimensions to be checked on site, any discrepancies reported prior to work commencing. IF IN DOUBT PLEASE ASK.
- All work and materials are to be in accordance with the relevant British Standards and Code of Practice.
- All Proprietary products are to be used strictly in accordance with the manufacturer's instructions and details.

Planting Schedule										
Nr	Code	Plant Name	Height/Spread/Grade	Girth	Age	Root	Container	Habit	Form	Density/m2
Herbaceous										
140	Pms Is	Prunus lusitanica	60-80cm			C	10-15L	Bushy		5.00
Shrub										
54	Am	Alchemilla mollis	15-20cm			C	3L			6.00
36	ASB5	Astibe arenalis 'Snowdrift'	30-40cm			C	3L			6.00
117	Bgn cr	Bergenia cordifolia	30-40cm			C	3L	Branched		6.00
117	Cr la	Crocus laevigatus	10-15cm					Bulb		40.00
23	Gr In	Gaura lindheimeri	30-40cm			C	3L			6.00
137	Nic F	Narcissus 'Ice Follies'	10-15cm					Bulb		40.00
142	Nic M	Narcissus 'Minnow'	10-15cm					Bulb		40.00
18	Thy vl	Thymus vulgaris	20-25cm			C	5L			4.00
Tree										
17	Al (M-S)	Amelanchier lamarckii (multi-stem)	200-250cm					Multi-stem		
2	BeE	Betula 'Idenburgi'	350-425cm	12-14cm	3x	WB		Standard (extra-heavy)		
2	Buj	Betula utilis jacquemontii	300-350cm		2x	RB		Multi-stem		
2	Cms ks	Cornus kousa	175-200cm		3x	C	30-50L	Multi-stem		
9	Ma dom	Malus domestica	350-425cm	12-14cm		RB		Standard (extra-heavy)		
4	Mxl	Magrolia x siebneri 'Leonard Messel'	200-250cm		4x	C	30L	Multi-stem		
7	PcC	Pinus catteriana 'Chanticleer'	350-425cm	12-14cm	3x	RB		Standard (Heavy)		
4	Sal	Sorbus aria 'Lutescens'	350-425cm	12-14cm	3x	RB		Standard (Extra heavy)		
4	Ti cr	Tilia cordata	450-425cm	14-16cm	3x	RB		Standard (extra-heavy)		

Planting Schedule (Mix)										
Nr	Code	Plant Name	Mix%	Height/Spread/Grade	Girth	Age	Root	Container	Habit	Density/m2
40	Crys av	Corylus avellana	20.00 %	60-90cm			BR			3.00
50	Il aq	Ilex aquifolium	25.00 %	60-90cm		1/1	BR		Transplant (seed-raised)	3.00
50	Pms sp	Prunus spinosa	25.00 %	60-90cm		1u1	BR		Branched	3.00
30	Sn	Sambucus nigra	15.00 %	60-90cm			C	3L	Branched	3.00
30	Vo	Viburnum opulus	15.00 %	60-90cm			BR		Branched	3.00

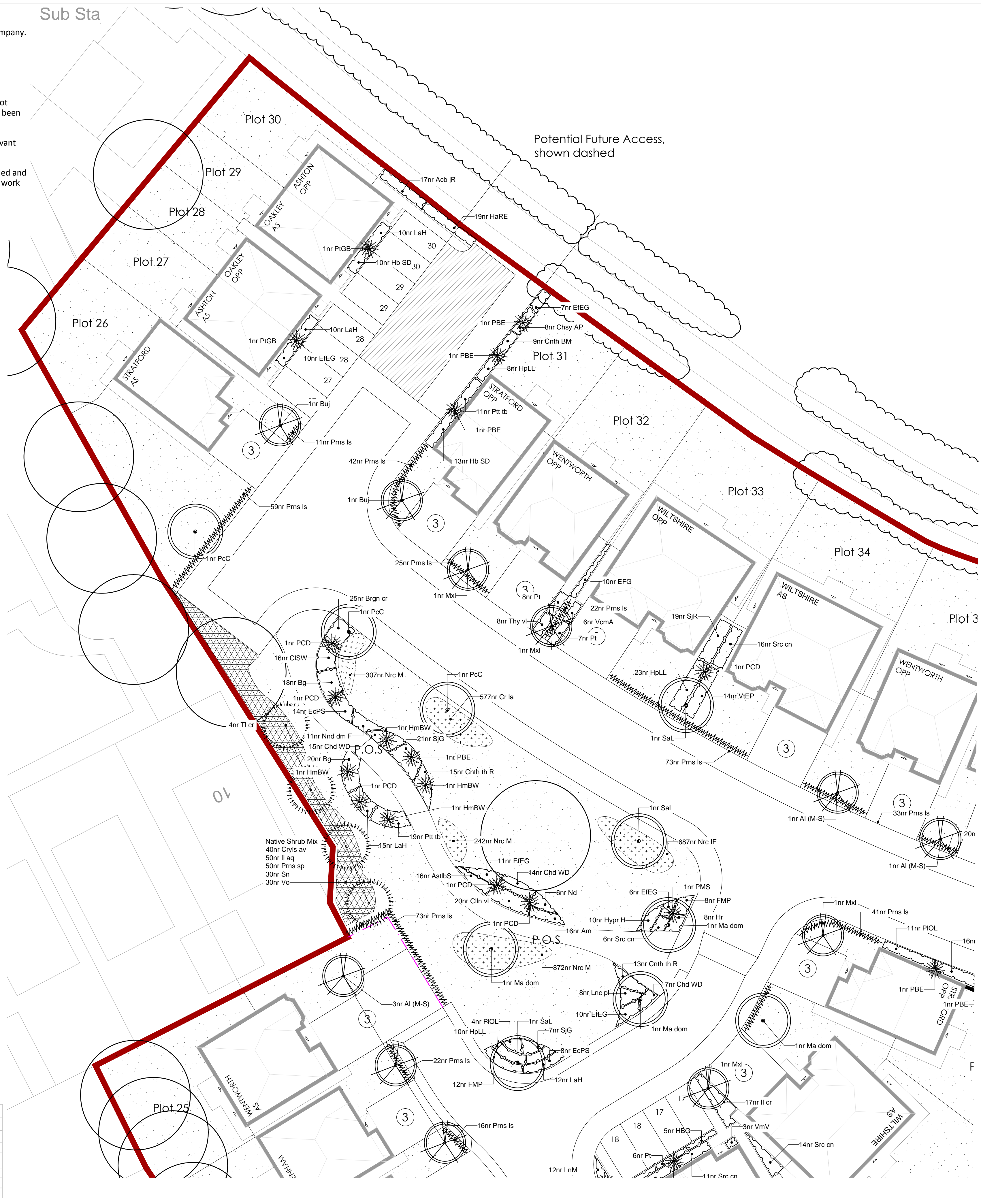

**LEGEND**

- SOFT LANDSCAPE**
- Existing Trees and Hedges to be retained
  - Existing Trees and Hedges to be removed
  - Proposed Tree in POS**  
Extra Heavy Standard, 14-16cm girth, 4.5-6.25m high to be planted with a double timber stake secured with a rubber tie.
  - Proposed Ornamental Tree**  
Heavy Standard, 12-14cm girth, 3.5-4.25m high to be planted with a double timber stake secured with a rubber tie.
  - Proposed Small Ornamental Tree/Large Shrub**  
Selected Standard, 10-12cm girth, 3-3.5m high or large shrub 30-50L to be planted with a single timber stake secured with a rubber tree tie.
  - Proposed Semi-Native Mix**  
Mixed semi-native shrub planting, 60-90cm high, BR stock or 3ltr pots at 2-3/sq.m.
  - Proposed Formal Hedge**  
Low hedge to be planted at 60-80cm BR stock at 5 per lin.m
  - Proposed Ornamental Planting**  
Mixed shrub planting 3ltr pots. Planting beds to receive 75mm depth ornamental bark mulch.
  - Proposed Grass POS**  
Grass within POS to be seeded with hard wearing grass mix.
  - Proposed Grass and Top Soil**  
Grass in front gardens to be turfed. Back gardens to be topsoil
  - Proposed Bulb Planting**  
To be planted with seasonal bulbs.

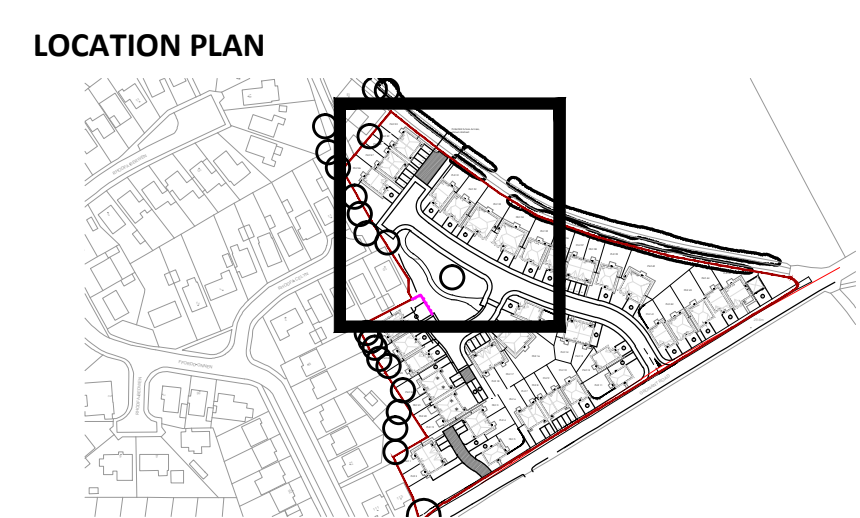

**REVISION NOTES**

Rev	By	Description	Date
A	JW	Revised in line with new layout	28.11.22

Client  
**Macbraydes Homes**

Project  
**Midnant Farm, Gronant Road, Prestatyn**

Description  
**Planting Plan (1 of 3)**

Status  
**For Approval**

Scale @ A1  
**1:200**

Drawn  
**FZ**

Checked  
**KP**

Date  
**22.07.22**

Job number  
**4169**

Drawing number  
**201**

Revision  
**A**

**tpm landscape**  
chartered landscape architects

address: 4th Floor Studio 10 Little Lever St Manchester M1 1HR  
tel: 0161 235 0600 fax 0601 email info@tpmlandscape.co.uk